



.4 hp Die Grinders & Disc Sanders

NEW!

NEW Lightweight Ergonomic Design!



- Ideal for Rapid Material Removal, Sanding, Deburring, Finishing
- Right Angle, 7° Offset & Angle-Head Models
- Plus Angle-Head Drill, Buffer & Random Orbital Sander



Dynabrade .4 hp Die Grinders

Dynabrade .4 hp Die Grinders are ideal for rapid material removal, deburring, finishing and polishing. Featuring **NEW** lightweight design, these innovative tools offer time-saving solutions to countless manufacturing and fabrication industries, including foundries, welding operations, die shops, shipyards, nuclear facilities and more!



Right Angle Models, Front & Rear Exhaust

- Each model includes **1/4" Collet** and **6 mm Collet**.
- Governor-controlled air motor maintains speed under load.
- Tool weight is .5 oz. (15 g) lighter than previous models!
- Ergonomic tool housing with comfortable "soft touch" grip.
- Safety-lock throttle lever included, for maximum safety.

Front Exhaust

Model 47800 12,000 RPM

Model 47801 15,000 RPM

Model 47802 20,000 RPM



Model Number	Motor hp (W)	Motor RPM	Sound Level	Maximum Air Flow SCFM (L/Min)	Hose I.D. Size Inch (mm)	Air Inlet Thread	Air Pressure PSIG (Bar)	Weight Pound (kg)	Length Inch (mm)	Height Inch (mm)
47800	.4 (298)	12,000	84 dB(A)	25 (708)	1/4 (6)	1/4" NPT	90 (6.2)	1.0 (.46)	6 (150)	2.9 (73)
47801	.4 (298)	15,000	86 dB(A)	25 (708)	1/4 (6)	1/4" NPT	90 (6.2)	1.0 (.46)	6 (150)	2.9 (73)
47802	.4 (298)	20,000	85 dB(A)	25 (708)	1/4 (6)	1/4" NPT	90 (6.2)	1.0 (.46)	6 (150)	2.9 (73)

Tune-Up Kit: No. 96541

Rear Exhaust with Extended Muffler

- Extended muffler ensures lowest sound levels.

Model 46000 12,000 RPM

Model 46001 15,000 RPM

Model 46002 20,000 RPM



Model Number	Motor hp (W)	Motor RPM	Sound Level	Maximum Air Flow SCFM (L/Min)	Hose I.D. Size Inch (mm)	Air Inlet Thread	Air Pressure PSIG (Bar)	Weight Pound (kg)	Length Inch (mm)	Height Inch (mm)
46000	.4 (298)	12,000	78 dB(A)	25 (708)	1/4 (6)	1/4" NPT	90 (6.2)	1.2 (.55)	8 (203)	2.9 (73)
46001	.4 (298)	15,000	75 dB(A)	25 (708)	1/4 (6)	1/4" NPT	90 (6.2)	1.2 (.55)	8 (203)	2.9 (73)
46002	.4 (298)	20,000	78 dB(A)	25 (708)	1/4 (6)	1/4" NPT	90 (6.2)	1.2 (.55)	8 (203)	2.9 (73)

Tune-Up Kit: No. 96541

Rear Exhaust with Standard Muffler

- Standard muffler for more compact design.

Model 49425 3,200 RPM

Model 48315 12,000 RPM

Model 48316 15,000 RPM

Model 48317 20,000 RPM



Model 48315

Ask about our Vacuum Die Grinders!

Model Number	Motor hp (W)	Motor RPM	Sound Level	Maximum Air Flow SCFM (L/Min)	Hose I.D. Size Inch (mm)	Air Inlet Thread	Air Pressure PSIG (Bar)	Weight Pound (kg)	Length Inch (mm)	Height Inch (mm)
48315	.4 (298)	12,000	81 dB(A)	25 (708)	1/4 (6)	1/4" NPT	90 (6.2)	1 (.47)	6.5 (164)	2.9 (73)
48316	.4 (298)	15,000	79 dB(A)	25 (708)	1/4 (6)	1/4" NPT	90 (6.2)	1 (.47)	6.5 (164)	2.9 (73)
48317	.4 (298)	20,000	83 dB(A)	25 (708)	1/4 (6)	1/4" NPT	90 (6.2)	1 (.47)	6.5 (164)	2.9 (73)
49425	.4 (298)	3,200	81 dB(A)	25 (708)	1/4 (6)	1/4" NPT	90 (6.2)	1.5 (.68)	7.7 (196)	2.9 (73)

Tune-Up Kit: No. 96541

7° Offset Models, Rear Exhaust

- Each model includes **1/4" Collet** and **6 mm Collet**.
- Tool weight is .5 oz. (15 g) lighter than previous models!
- Ergonomic tool housing with comfortable “soft touch” grip.
- Safety-lock throttle lever included.

Extended Muffler

- Extended muffler ensures lowest sound levels.
- Gearless motor for reduced maintenance and downtime.

Model 48205 25,000 RPM

Model 48207 30,000 RPM



Model
48205



Model
48337

Model Number	Motor hp (W)	Motor RPM	Sound Level	Maximum Air Flow SCFM (L/Min)	Hose I.D. Size Inch (mm)	Air Inlet Thread	Air Pressure PSIG (Bar)	Weight Pound (kg)	Length Inch (mm)	Height Inch (mm)
48205	.4 (298)	25,000	71 dB(A)	23 (651)	1/4 (6)	1/4" NPT	90 (6.2)	1.3 (.57)	8.9 (225)	3.8 (97)
48207	.4 (298)	30,000	72 dB(A)	23 (651)	1/4 (6)	1/4" NPT	90 (6.2)	1.3 (.57)	8.9 (225)	3.8 (97)

Tune-Up Kit: No. 96541

Extended Muffler (Slow Speed)

- Extended muffler ensures lowest sound levels.
- Slow speeds allow additional use as a buffing tool.

Model 47211 3,200 RPM

Model 47212 5,000 RPM



Model
47211

Model Number	Motor hp (W)	Motor RPM	Sound Level	Maximum Air Flow SCFM (L/Min)	Hose I.D. Size Inch (mm)	Air Inlet Thread	Air Pressure PSIG (Bar)	Weight Pound (kg)	Length Inch (mm)	Height Inch (mm)
47211	.4 (298)	3,200	73 dB(A)	23 (651)	1/4 (6)	1/4" NPT	90 (6.2)	1.7 (.78)	9 (228)	5.6 (143)
47212	.4 (298)	5,000	75 dB(A)	23 (651)	1/4 (6)	1/4" NPT	90 (6.2)	1.7 (.78)	9 (228)	5.6 (143)

Tune-Up Kit: No. 96541

Standard Muffler

- Standard muffler for more compact design.
- Gearless motor for reduced maintenance and downtime.

Model 48335 25,000 RPM

Model 48337 30,000 RPM



Model
48335



Gearless

Model Number	Motor hp (W)	Motor RPM	Sound Level	Maximum Air Flow SCFM (L/Min)	Hose I.D. Size Inch (mm)	Air Inlet Thread	Air Pressure PSIG (Bar)	Weight Pound (kg)	Length Inch (mm)	Height Inch (mm)
48335	.4 (298)	25,000	73 dB(A)	23 (651)	1/4 (6)	1/4" NPT	90 (6.2)	1 (.47)	7.3 (186)	3.8 (97)
48337	.4 (298)	30,000	74 dB(A)	23 (651)	1/4 (6)	1/4" NPT	90 (6.2)	1 (.47)	7.3 (186)	3.8 (97)

Tune-Up Kit: No. 96541

Angle-Head Model, Rear Exhaust with Extended Muffler

- Governor-controlled air motor maintains speed under load.
- Includes **50055 Collet** (1/4" only).
- Extended muffler ensures lowest sound levels.
- Safety-lock throttle lever included.
- Optional 54585 Side Handle Assembly is available.

Model 49420 3,200 RPM



Model
49420

2.1"
(53 mm)

Model Number	Motor hp (W)	Motor RPM	Sound Level	Maximum Air Flow SCFM (L/Min)	Hose I.D. Size Inch (mm)	Air Inlet Thread	Tool Thread	Weight Pound (kg)	Length Inch (mm)	Diameter Inch (mm)
49420	.4 (298)	3,200	80 dB(A)	26 (736)	1/4 (6)	1/4" NPT	1/4"-28 Female	1.9 (0.8)	11.7 (296)	2.1 (53)

Tune-Up Kit: No. 96541 • Additional Specifications: Air Pressure 90 PSIG (6.2 Bar)

Dynabrade .4 hp Disc Sanders

Dynabrade .4 hp Disc Sanders feature **NEW** lightweight design, ideal for fast weld removal, metal beveling in weld preparation, deburring and deflashing, surface conditioning, paint removal and more!

2" Diameter Models, Front & Rear Exhaust

- Each model on page includes **51344 Locking-Type Disc Pad**.
- Ergonomic tool housing with comfortable "soft touch" grip.
- Tool weight is .5 oz. (15 g) lighter than previous models!
- Safety-lock throttle lever included, for maximum safety.



7° Offset, Rear Exhaust

- Handle is offset 7° for greater operator comfort and control.
- Gearless motor for reduced maintenance and downtime.

Model 48500 **25,000 RPM**

- Extended muffler ensures lowest sound levels.

Model 48503 **25,000 RPM**

- Standard muffler for more compact design.



Model Number	Motor hp (W)	Motor RPM	Sound Level	Maximum Air Flow SCFM (L/Min)	Hose I.D. Size Inch (mm)	Air Inlet Thread	Tool Thread	Weight Pound (kg)	Length Inch (mm)	Height Inch (mm)
48500	.4 (298)	25,000	73 dB(A)	23 (650)	1/4 (6)	1/4" NPT	1/4"-20 Male	1.3 (0.6)	8.7 (222)	3.9 (98)
48503	.4 (298)	25,000	73 dB(A)	23 (650)	1/4 (6)	1/4" NPT	1/4"-20 Male	1.1 (.5)	7.2 (183)	3.9 (98)

Tune-Up Kit: No. 96541 • Additional Specifications: Air Pressure 90 PSIG (6.2 Bar)

Right Angle, Front Exhaust

- Governor-controlled air motor maintains speed under load.

Model 47820 **12,000 RPM**

Model 47821 **15,000 RPM**

Model 47822 **20,000 RPM**



**Ask about
our Vacuum
Disc Sanders!**

Model Number	Motor hp (W)	Motor RPM	Sound Level	Maximum Air Flow SCFM (L/Min)	Hose I.D. Size Inch (mm)	Air Inlet Thread	Tool Thread	Weight Pound (kg)	Length Inch (mm)	Height Inch (mm)
47820	.4 (298)	12,000	85 dB(A)	25 (708)	1/4 (6)	1/4" NPT	1/4"-20 Male	1.1 (0.5)	4.4 (111)	3.5 (89)
47821	.4 (298)	15,000	85 dB(A)	25 (708)	1/4 (6)	1/4" NPT	1/4"-20 Male	1.1 (0.5)	4.4 (111)	3.5 (89)
47822	.4 (298)	20,000	84 dB(A)	25 (708)	1/4 (6)	1/4" NPT	1/4"-20 Male	1.1 (0.5)	4.4 (111)	3.5 (89)

Tune-Up Kit: No. 96541 • Additional Specifications: Air Pressure 90 PSIG (6.2 Bar)

Right Angle, Rear Exhaust with Extended Muffler

- Extended muffler ensures lowest sound levels.
- Governor-controlled air motor maintains speed under load.

Model 48520 **12,000 RPM**

Model 48521 **15,000 RPM**

Model 48522 **20,000 RPM**



Model Number	Motor hp (W)	Motor RPM	Sound Level	Maximum Air Flow SCFM (L/Min)	Hose I.D. Size Inch (mm)	Air Inlet Thread	Tool Thread	Weight Pound (kg)	Length Inch (mm)	Height Inch (mm)
48520	.4 (298)	12,000	76 dB(A)	27 (765)	1/4 (6)	1/4" NPT	1/4"-20 Male	1.3 (0.6)	8.2 (208)	3.5 (89)
48521	.4 (298)	15,000	79 dB(A)	27 (765)	1/4 (6)	1/4" NPT	1/4"-20 Male	1.3 (0.6)	8.2 (208)	3.5 (89)
48522	.4 (298)	20,000	78 dB(A)	27 (765)	1/4 (6)	1/4" NPT	1/4"-20 Male	1.3 (0.6)	8.2 (208)	3.5 (89)

Tune-Up Kit: No. 96541 • Additional Specifications: Air Pressure 90 PSIG (6.2 Bar)

Right Angle, Rear Exhaust with Standard Muffler

- Standard muffler for more compact design.
- Includes **51344 Locking-Type Disc Pad** (2" diameter).
- Governor-controlled air motor maintains speed under load.

Model 48540 12,000 RPM

Model 48541 15,000 RPM

Model 48542 20,000 RPM



Model
48540



Visit
Dynabrade.com

Model Number	Motor hp (W)	Motor RPM	Sound Level	Maximum Air Flow SCFM (L/Min)	Hose I.D. Size Inch (mm)	Air Inlet Thread	Tool Thread	Weight Pound (kg)	Length Inch (mm)	Height Inch (mm)
48540	.4 (298)	12,000	81 dB(A)	27 (765)	1/4 (6)	1/4" NPT	1/4"-20 Male	1.1 (0.5)	4.9 (124)	3.5 (89)
48541	.4 (298)	15,000	83 dB(A)	27 (765)	1/4 (6)	1/4" NPT	1/4"-20 Male	1.1 (0.5)	4.9 (124)	3.5 (89)
48542	.4 (298)	20,000	81 dB(A)	27 (765)	1/4 (6)	1/4" NPT	1/4"-20 Male	1.1 (0.5)	4.9 (124)	3.5 (89)

Tune-Up Kit: No. 96541 • Additional Specifications: Air Pressure 90 PSIG (6.2 Bar)

2" Diameter Angle-Head Model, Rear Exhaust with Extended Muffler

Model 49410 3,200 RPM

- Tool has 1/4"-28 female thread. Comes mounted with 54021 Adapter for pads with 1/4"-20 female thread.
- Includes **50107 Pad** (2" diameter) for PSA (adhesive backed) abrasive discs.
- Governor-controlled motor maintains speed under load.
- Safety-lock throttle lever included, for maximum safety.
- Optional 54030 Rotary Sanding Head permits locking-type male thread pad to be mounted.
- Optional 54585 Side Handle available.



Model
49410

Model Number	Motor hp (W)	Motor RPM	Sound Level	Maximum Air Flow SCFM (L/Min)	Hose I.D. Size Inch (mm)	Air Inlet Thread	Tool Thread	Weight Pound (kg)	Length Inch (mm)	Height Inch (mm)
49410	.4 (298)	3,200	78 dB(A)	26 (736)	1/4 (6)	1/4" NPT	1/4"-28 Female	1.9 (0.9)	12.5 (319)	2.6 (65)

Tune-Up Kit: No. 96541 • Additional Specifications: Air Pressure 90 PSIG (6.2 Bar)

3" Diameter Model, Rear Exhaust

- Governor-controlled air motor maintains speed under load.
- Each model includes **51346 Locking-Type Disc Pad**.
- Ergonomic tool housing with comfortable "soft touch" grip.
- Tool weight is .5 oz. (15 g) lighter than previous models!
- Safety-lock throttle lever included, for maximum safety.

Right Angle, Extended Muffler

- Extended muffler ensures lowest sound levels.

Model 48530 12,000 RPM

Model 48531 15,000 RPM

Model 48532 20,000 RPM



Model
48530



Model
48530

Model Number	Motor hp (W)	Motor RPM	Sound Level	Maximum Air Flow SCFM (L/Min)	Hose I.D. Size Inch (mm)	Air Inlet Thread	Tool Thread	Weight Pound (kg)	Length Inch (mm)	Height Inch (mm)
48530	.4 (298)	12,000	81 dB(A)	21 (595)	1/4 (6)	1/4" NPT	1/4"-20 Male	1.2 (0.5)	7-3/8 (187)	3-1/8 (79)
48531	.4 (298)	15,000	80 dB(A)	21 (595)	1/4 (6)	1/4" NPT	1/4"-20 Male	1.2 (0.5)	7-3/8 (187)	3-1/8 (79)
48532	.4 (298)	20,000	83 dB(A)	21 (595)	1/4 (6)	1/4" NPT	1/4"-20 Male	1.2 (0.5)	7-3/8 (187)	3-1/8 (79)

Tune-Up Kit: No. 96541 • Additional Specifications: Air Pressure 90 PSIG (6.2 Bar)

.4 hp Angle-Head Tools

With Extended Rear Exhaust Muffler



Angle-Head Drill

- Accepts 1/4"-28 threaded drill bits, sold separately.
- Angle height of only 1.2" (30 mm).
- Governor-controlled motor maintains speed under load.
- Safety-lock throttle lever included, for maximum safety.



Model 49455 950 RPM

- USA Government National Stock Number 5130015498848.

Model 49430 3,200 RPM

Model Number	Motor hp (W)	Motor RPM	Sound Level	Maximum Air Flow SCFM (L/Min)	Hose I.D. Size Inch (mm)	Air Inlet Thread	Spindle Thread	Weight Pound (kg)	Length Inch (mm)	Height Inch (mm)
49430	.4 (298)	3,200	79 dB(A)	26 (736)	1/4 (6)	1/4" NPT	1/4"-28 Female	1.9 (.9)	11.7 (296)	1.2 (30)
49455	.4 (298)	950	77 dB(A)	26 (736)	1/4 (6)	1/4" NPT	1/4"-28 Female	2.1 (.9)	13 (329)	1.2 (30)

Tune-Up Kit: No. 96541

Angle-Head Buffer

Model 49440 3" Diameter, 3,200 RPM

- Tool comes mounted with 54021 Adapter (1/4"-20 male thread). Safety-lock throttle lever, rotary action.
- Governor-controlled motor maintains speed under load.
- Includes 50120 Hook-Face Pad (3" diameter), which mounts directly to 54021 Adapter.
- Also includes 90027 Terry Cloth Bonnet and 90028 Wool Buffing Bonnet.

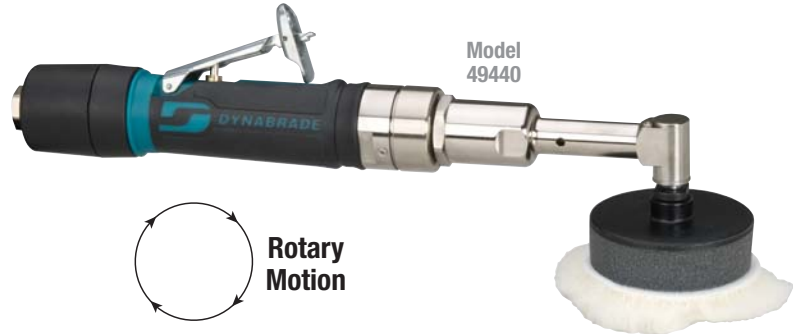

Model Number	Motor hp (W)	Motor RPM	Sound Level	Maximum Air Flow SCFM (L/Min)	Hose I.D. Size Inch (mm)	Air Inlet Thread	Tool Thread	Weight Pound (kg)	Length Inch (mm)	Height Inch (mm)
49440	.4 (298)	3,200	79 dB(A)	26 (736)	1/4 (6)	1/4" NPT	1/4"-28 Female	1.9 (.9)	13 (331)	2.6 (67)

Tune-Up Kit: No. 96541 • Additional Specifications: Air Pressure 90 PSIG (6.2 Bar)

Angle-Head Mini-Dynorbital®

- Built-in speed regulator, safety-lock throttle lever included.
- Governor-controlled motor maintains speed under load.
- Sample 9-micron micro-finishing film discs are included.
- Optional 54585 Side Handle Assembly available.

Model 49400 3,200 RPM

- 54028 Random Orbital Sanding Head accepts sanding pads with 1/4"-20 female thread.
- Includes 1-1/4" dia. medium density pad (54018), which has 1/4"-20 female thread and mounts to sanding head.

Model 49401 3,200 RPM

- 54029 Random Orbital Sanding Head accepts male locking-type pads.
- Includes 1-1/4" dia. soft density locking-type pad (54031), which has male locking-type thread and mounts to sanding head.



Model Number	Motor hp (W)	Motor RPM	Sound Level	Maximum Air Flow SCFM (L/Min)	Hose I.D. Size Inch (mm)	Air Inlet Thread	Tool Thread	Weight Pound (kg)	Length Inch (mm)	Height Inch (mm)
49400	.4 (298)	3,200	80 dB(A)	26 (736)	1/4 (6)	1/4" NPT	1/4"-28 Female	1.9 (.9)	12.4 (316)	3 (77)
49401	.4 (298)	3,200	80 dB(A)	26 (736)	1/4 (6)	1/4" NPT	1/4"-28 Female	1.9 (.9)	12.4 (316)	2.9 (74)

Tune-Up Kit: No. 96541 • Additional Specifications: Air Pressure 90 PSIG (6.2 Bar)

Angle-Head Versatility Kit

Excellent for Repairing Dust Nibs on Clearcoat, Minor Surface Defects

49403 Sander/Buffer Versatility Kit

- Includes: 3,200 RPM air tool, 54028 Random Orbital Sanding Head, 50120 Hook 'n Loop Pad for Bonnets, 54018 Sanding Pad, 54021 Adapter, 90028 Wool Bonnet, assorted wrenches, 90027 Terry Cloth Bonnet, 95723 Finesse Sanding Creme, 95727 Dynabrade Glaze, 54017 Sanding Pad and sample abrasives.

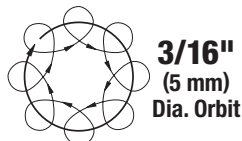









Carbide Burrs & Kit

For Use With Die Grinders on Pages 2-3

93350 1/4" Dynaburr Carbide Burr Kit

- Used for grinding, deburring, and finishing on stainless steel and other metals.
- For use with 1/4" Collet Die Grinders.
- All Carbide Burrs may be ordered separately (see below).
- 8 piece kit includes: 93330, 93331, 93332, 93333, 93334, 93335, 93336, 93337.
- Packaged in high-quality wooden case.
- 6 mm Carbide Burr Kit (93380) also available.



								
Shape	Cylinder	Cylinder	Cylinder Radiused End	Cylinder Radiused End	Ball	Oval	Tree Radiused End	Taper Radiused End
Tool Style	SA-1	SA-3	SC-1	SC-3	SD-3	SE-3	SF-3	SL-3
Cut Style	Double	Double	Double	Double	Double	Double	Double	Double
1/4" Part No.	93330	93331	93332	93333	93334	93335	93336	93337
Cutter Dia.	1/4"	3/8"	1/4"	3/8"	3/8"	3/8"	3/8"	3/8"
Flute Length	5/8"	3/4"	5/8"	3/4"	5/16"	5/8"	3/4"	1-1/16"
Shank	1/4"	1/4"	1/4"	1/4"	1/4"	1/4"	1/4"	1/4"
6 mm Part No.	93360	93361	93362	93363	93364	93365	93366	93367
Cutter Dia.	6 mm	9 mm	6 mm	9 mm	9 mm	9 mm	9 mm	9 mm
Flute Length	16 mm	19 mm	16 mm	19 mm	8 mm	16 mm	19 mm	27 mm
Shank	6 mm	6 mm	6 mm	6 mm	6 mm	6 mm	6 mm	6 mm

Dynaswivel® Air Line Connector

Never Fight an Air Hose Again!

- The Dynaswivel® is a patented "universal-joint" that connects portable air tools to an air line.
- Swivels 360° AT TWO PIVOT POINTS, allowing the air hose to drop directly to the floor while providing superb tool handling.
- Improves tool maneuverability and air flow, minimizes operator fatigue and extends hose life.
- Many other configurations available.



95460
Aluminum,
1/4" NPT

94300
Composite,
1/4" NPT



Disc Sander Backup Pads

For Use With Models on Pages 4-5

Pads for Locking-Type Discs

2" (51 mm) and 3" (76 mm) Dia. Pads

- A quick turn of the disc locks it into place.
- 2" (51 mm) and 3" (76 mm) dia. pads include 50103 Pad Adapter to convert 1/4"-20 female thread to 1/4" dia. shank, for use with Collets and Chucks.



Pad Diameter	Part Number	Pad MOS RPM	Thread	Density
2" (51 mm)	51344*	30,000	1/4"-20 Female	Medium
	51345	30,000	3/8"-24 Female	Medium
3" (76 mm)	51346*	20,000	1/4"-20 Female	Medium
	51347	20,000	3/8"-24 Female	Medium

*Includes 50103 Pad Adapter to convert 1/4"-20 female thread to 1/4" dia. shank for use with collets and chucks



50111 Disc Pad Conversion Assembly

2" (51 mm) Dia. Pad

- Includes 50107 PSA Disc Pad and 50103 Pad Adapter. Converts 1/4"-20 female thread to 1/4" dia. shank, for use with Collets and Chucks.



Pads for PSA-Type Discs

2" (51 mm) Dia. Pad

- Easy application and removal of disc. Remove the disc's liner to reveal a pressure-sensitive adhesive coating. Peel the old disc off the pad, and press on the new disc!



Pad Diameter	Part Number	Pad MOS RPM	Thread	Density
2" (51 mm)	50107	20,000	1/4"-20 Female	Medium
	50109	20,000	3/8"-24 Female	Medium



For More Tools and Related Accessories, Visit: **Dynabrade.com**



Contract Holder



Contract Holder



DYNABRADE, INC. • DYNABRADE INTERNATIONAL

8989 Sheridan Drive • Clarence, New York 14031-1419
Phone: (716) 631-0100 • US Fax: 716-631-2073 • Int'l Fax: 716-631-2524

US Consumers Call Toll-Free: 1-800-828-7333

Canadian Consumers Call Toll-Free: 1-800-344-1488

DYNABRADE EUROPE S.à r.l.

Zone Artisanale Op Tomm 6 • L-5485 Wormeldange—Haut, Luxembourg
Telephone: +352 768 494 1 • Fax: +352 768 495

DYNABRADE DO BRASIL LTDA.

Av. Kennedy 914 - CJ 32 • São Bernardo do Campo • SP - CEP 09726-253
Telephone 55-11-4390-0133 • Fax 55-11-4399-1067

DYNABRADE INDIA ABRASIVE POWER TOOLS Pvt Ltd.

EL-54, TTC Industrial Area, M.I.D.C. Mahape, Electronic Zone, Navi Mumbai - 400705
Maharashtra, India • Telephone: +91 22 2763 2226 • Fax: +91 22 2763 2228

U.S. Consumer Toll-Free Number: 1-888 DYNABRADE

DISTRIBUTED BY:



Two-Step System for Clear Coat Repair

With Buffing Time REDUCED by up to 40%!



- NEW Random Orbital Sander and Dynabuffer with Exciting Innovations
- Proven Method for Repairing Surface Defects in Clear Coat
- System Eliminates Swirl Marks, Hazing and Compound Sliding



Mini-Dynorbital® Silver Supreme

Palm-Style Random Orbital Sander



Dynabrade introduces **NEW Mini-Dynorbital® Silver Supreme**, ideal for repairing minor surface defects in clear coat and other surfaces. Offering all our Silver Supreme innovations, this tool is compact and efficient: another cutting-edge example of The Dynabrade Difference!

Comfort Platform

U.S. Patent no. D610,428

Provides additional hand and wrist support, enhancing operator comfort. Also offers protection against cold air exhaust.

Auto-Recess Throttle Lever

Lever recesses into housing when depressed, eliminating pressure point on operator's palm.

Compact Tool Grip

Compact, vibration-absorbing design allows more comfortable grip, reducing operator fatigue and increasing efficiency.

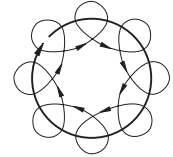

3/16" (5 mm) Diameter Orbital Motion

Reduced Vibration

New design minimizes tool vibration, achieving a more consistent finish.

Tool Height Reduced by 20%

Low profile design allows enhanced operator control.

High-Quality Sanding Pad

Each model includes vinyl-face Sanding Pad, 1-1/4" (32 mm) in diameter.

Tool Weight of only 1.3 lbs. (0.6 kg)!

Lightweight design reduces operator fatigue, especially in vertical applications.

Convenient Hanger Bracket

Non-marring bracket allows tool to be safely hung when not in use.

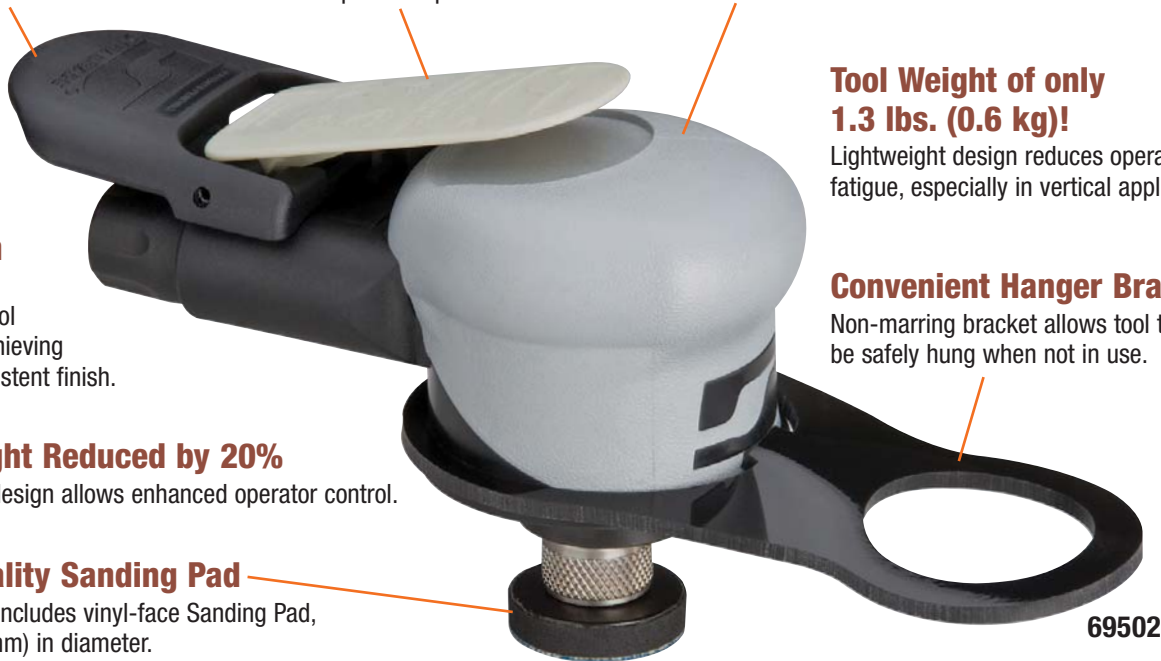

69502

Mini-Dynorbital® Silver Supreme

- 3/16" (5 mm) random orbital motion achieves ultra-smooth finish on coated surfaces, wood, composites and more.
- Ideal for repairing dust nibs and surface defects in clear coat.

Model 69500 5,000 RPM

- Includes 54018 pad, 1/4"-20 thread.

Model 69502 7,500 RPM

- Includes 54037 locking-type pad.

Model 69503 5,000 RPM

- Includes 54037 locking-type pad.

Model 69504 7,500 RPM

- Includes 54018 pad, 1/4"-20 thread.

NEW! Sanding Pad

54037 Locking-Type Pad

54037

For Use With 69502 and 69503 Tool

- High-quality, medium density vinyl-face pad.
- 1-1/4" (32 mm) diameter.



Model Number	Motor hp (W)	Motor RPM	Sound Level	Maximum Air Flow SCFM (LPM)	Tool Thread	Hose I.D. Inch (mm)	Air Inlet Thread	Weight Pound (kg)	Length Inch (mm)	Height Inch (mm)
69500	.03 (23)	5,000	70 dB(A)	5 (153)	1/4"-20	1/4 (6)	1/4" NPT	1.3 (.6)	6 (152)	3-5/16 (84)
69503	.03 (23)	5,000	70 dB(A)	5 (153)	Locking	1/4 (6)	1/4" NPT	1.3 (.6)	6 (152)	3-5/16 (84)
69502	.08 (60)	7,500	75 dB(A)	6 (170)	Locking	1/4 (6)	1/4" NPT	1.3 (.6)	6 (152)	3-5/16 (84)
69504	.08 (60)	7,500	75 dB(A)	6 (170)	1/4"-20	1/4 (6)	1/4" NPT	1.3 (.6)	6 (152)	3-5/16 (84)

Additional Specifications: Air Pressure 90 PSIG (6.2 Bar)

Dynabuffer

Front Exhaust Buffing Tool

➤ **Buffing Time REDUCED
by up to 40%!**

NEW!

A **NEW** version of Dynabrade's world-famous Dynabuffer, with unique advancements to **REDUCE** buffing time by up to 40%! Utilized worldwide to efficiently polish sanding scratches, Dynabuffer now offers increased power and speed, plus front exhaust to extend buffing pad life!

Safety-Lock Throttle Lever

Prevents accidental start-up of tool. Lever has no sharp edges or "pinch-points."

NEW Rubber Grip

Comfortable grip helps protect operator from cold air transfer.

INCREASED Horsepower, Speed and Efficiency!

Robust air motor is more powerful and runs faster, reducing your buffing time by **up to 40%**!

Convenient Hanger Bracket

Non-marring bracket allows tool to be safely hung when not in use.

Unique Balancer for Smooth Performance

U.S. Patent No. 6,206,771

Patented balancer compensates for vibration, resulting in ultra-smooth performance.

Front Exhaust to Extend Buffing Pad Life

Patent Pending

Front exhausted air helps to cool foam buffing pad (sold separately). Pads last longer, reducing your inventory levels!

Hook-Face Backup Pad

Ask for the ORANGE!

Includes 56142 Hook-Face Pad, 3" (76 mm) in diameter.

NEW Easy-Access Speed Regulator

For Consistent Finishes!

- Easily adjust motor RPM with optional 3/32" (4 mm) hexagonal wrench.
- Adjust all tools to run at **same speed** at various distances from air source.
- Muffler cap rotates to protect regulator and **lock in** desired speed.



TECH TIP

Start ON and Stop ON!

Always place Dynabuffer **ON** the work surface before starting it, and keep tool **ON** the surface as you stop it. This prevents the buffing pad from detaching, and eliminates slinging of buffing compound.

Model Number	Motor hp (W)	Motor RPM	Sound Level	Maximum Air Flow SCFM (LPM)	Female Thread	Hose I.D. Inch (mm)	Air Inlet Thread	Weight Pound (kg)	Length Inch (mm)	Height Inch (mm)
55126	.5 (373)	12,000	79 dB(A)	37 (1,048)	5/16"-24	1/4 (6)	1/4" NPT	2.7 (1.2)	9-1/2 (241)	4-1/8 (105)

Additional Specifications: Air Pressure 90 PSIG (6.2 Bar)

Dynabrade Two-Step Polishing System

A Proven Method for Repairing Minor Surface Defects in Clear Coat



STEP ONE: SANDING 69502 Mini-Dynorbital® Silver Supreme

- Attach abrasive disc to sanding pad, then apply water to abrasive disc.
- Place sanding pad on surface defect, positioning pad slightly off-center. Apply light pressure.
- Throttle tool ON, and sand in random motion for about two seconds.
- Keep sanding pad FLAT on surface while sanding, allowing tool and abrasive to do the work. Try to keep sanded area as small as possible.
- With tool still running, move tool OFF work surface and then stop it.
- Wipe surface dry with clean, soft cloth.



STEP TWO: BUFFING 55126 Dynabuffer

- Apply small amount of polishing compound to optional buffing pad attached to Dynabuffer. Spread compound evenly to precondition pad.
- Apply small drop of polishing compound to work surface. Use pad to spread compound evenly over sanded area of surface.
- Place pad on sanded area and apply pressure (approximately 3 lbs./1.4 kg of pressure).
- Throttle tool ON, and adjust pressure to minimize vibration (finding the “sweet spot”).
- Move pad in random motion, keeping pad flat or tipped slightly forward.
- Throttle tool OFF with pad still on surface (“start ON and stop ON”).
- Wipe surface dry with clean, soft cloth.
- If imperfections are still visible, repeat Two-Step System.



See a VIDEO Demo at www.Dynabrade.com



Dynabrade Tools for Clear Coat Repair



Dynabrade offers a complete line of tools ideal for spot repair on clear coat and other surfaces. With an amazing range of ergonomic features and benefits, these tools have “The Dynabrade Difference” built right in!



Two-Step System Accessories

3" (76 mm) Diameter Vacuum Sanding Pad

For Use with 55126 Dynabuffer

Part No. 56142

- Hook-Face, premium urethane, medium density, 5/16"-24 thread.
- Also used with 3" (76 mm) diameter HiVac Random Orbital Sanders. 6 holes allow maximum source capture.



56142

*Ask for the
ORANGE!*

Ball-Swivel Plug

For Use with Mini-Dynorbital® Silver Supreme

Part No. 97016

- Plug "swivels" for great tool maneuverability!
- A natural fit with Dynabrade palm-style Random Orbital Sanders!
- Offers 53° conical range of motion, for added tool maneuverability and operator comfort.
- Ported plug design allows air flow of up to 74 SCFM (2,095 LPM).



97016

*53° Conical
Range of Motion*

Coupler/Plug Assembly

For Use With 55126 Dynabuffer

Part No. 95676

- Provides maximum air flow to tool.
- Assembly includes one Coupler (1/4" female thread) and one Plug (1/4" male thread).
- Maximum working pressure of 150 PSIG (10 Bar).

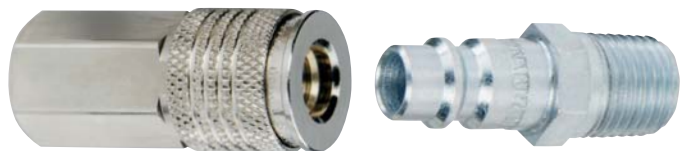

95676



Visit our Website for more Tools and Related Accessories
www.dynabrade.com

DYNABRADE, INC. • DYNABRADE INTERNATIONAL

8989 Sheridan Drive • Clarence, New York 14031-1419
Phone: (716) 631-0100 • US Fax: 716-631-2073 • Int'l Fax: 716-631-2524

US Consumers Call Toll-Free: 1-800-828-7333

Canadian Consumers Call Toll-Free: 1-800-344-1488

DYNABRADE EUROPE S.à r.l.

Zone Artisanale Op Tomm 6 • L-5485 Wormeldange—Haut, Luxembourg
Telephone: +352 768 494 1 • Fax: +352 768 495

DYNABRADE DO BRASIL

Rua Oneda, 632 • Sao Bernardo do Campo • SP - CEP 09895-280
Telephone 55-11-4390-0133 • Fax 55-11-4399-1067

DYNABRADE INDIA ABRASIVE POWER TOOLS Pvt Ltd.

EL-54, TTC Industrial Area, M.I.D.C. Mahape, Electronic Zone, Navi Mumbai - 400705
Maharashtra, India • Telephone: +91 22 2763 2226 • Fax: +91 22 2763 2228

DYNABRADE AUSTRALIA PTY LTD.

Unit 2, 13-14 National Drive, Hallam, Victoria 3803, Australia
Telephone: (03) 9796 5114 • Fax: (03) 9796 4113 • Toll-Free: 13001DYNA1

Try Our U.S. Consumer Toll-Free Number
1-888 DYNABRADE (or 1-800-828-7333)

DISTRIBUTED BY:



© DYNABRADE, INC., 2010

PRINTED IN U.S.A.



Dynastraight® and Dynisher® Finishing Tools

For Use on Stainless Steel and Other Surfaces



Dynastraight® & Dynisher Tools...



Quality tools designed to prepare, condition, finish, buff and polish on countless materials. For use with a variety of accessories and abrasives!

Finish First with Dynabrade!



Discover The Dynabrade Difference!

Dynastraight®

Air-Powered Abrasive Finishing Tool

For Graining, Cleaning and Polishing on Stainless Steel, Aluminum, Carbon Steel, Composites

Model 13200 950 RPM, .7 hp

Model 13500 950 RPM, 1 hp

- Each model includes 13071 Combo Arbor, for up to 3" wide wheels with 5/8" or 1" diameter center hole.

Arbors

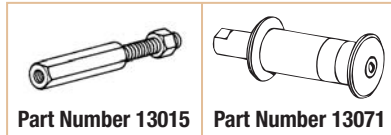

Part Number 13015

Part Number 13071

See page 17 for detailed arbor information.

13200 Dynastraight® runs optional Non-Woven Nylon Wheel.

FOR ABRASIVE BELTS, CONDITIONING DISCS, FLAP WHEELS

Up to 8" (203 mm) diameter

Model Number	Motor hp (W)	Motor RPM	Sound Level	Maximum Air Flow SCFM (L/Min)	Wheel Arbor Diameter	Air Inlet Thread	Tool Thread	Weight Pound (kg)	Length Inch (mm)	Height Inch (mm)
13200	.7 (522)	950	84 dB(A)	34 (952)	5/8" or 1"	1/4" NPT	1/2"-20 Male	4.7 (2.1)	14-7/8 (378)	1-3/4 (44)
13500	1 (744)	950	81 dB(A)	43 (1,218)	5/8" or 1"	3/8" NPT	1/2"-20 Male	5.2 (2.4)	15-3/4 (400)	1-7/8 (48)

Tune-Up Kit: 13200 – No. 96260; 13500 – No. 96532 • Additional Specifications: Hose I.D. Size 3/8" (10 mm) • Air Pressure 90 PSIG (6.2 Bar)

Model 13501 1,800 RPM, 1 hp

- 13071 Combo Arbor, for up to 3" wide wheels with 5/8" or 1" dia. center hole.
- Any Dynacushion® pneumatic wheel with 5/8" dia. bore (such as 92938) may be mounted.

Model 13521 1,800 RPM, 1 hp

- 13015 Threaded Arbor (5/8"-11) ideal for use with optional 94472 Dynacushion® Pneumatic Wheel.



When using pneumatic wheels, inflate wheel only enough to hold the abrasive belt without slippage. Over-inflating the wheel can lead to "chatter marks" on the surface.

Model 13511 1,800 RPM, 6" Extension, 1 hp

- 5/8" or 1" diameter combo arbor for up to 3" wide wheels with 5/8" or 1" diameter center hole.
- Any Dynacushion® pneumatic wheel with 5/8" dia. bore (such as 92938) may be mounted.
- Cushioned grip enhances operator comfort.

Model 13531 1,800 RPM, 6" Extension, 1 hp

- 5/8"-11 threaded arbor accepts up to 3-1/2" wide pneumatic wheels (not included) with threaded 5/8"-11 center hole. Ideal set-up for optional Dynacushion® pneumatic wheel with 5/8"-11 thread (such as 92805).
- Cushioned grip enhances operator comfort.



Model Number	Motor hp (W)	Motor RPM	Sound Level	Maximum Air Flow SCFM (L/Min)	Wheel Arbor Diameter	Air Inlet Thread	Tool Thread	Weight Pound (kg)	Length Inch (mm)	Height Inch (mm)
13501	1 (744)	1,800	84 dB(A)	34 (952)	5/8" or 1"	3/8" NPT	1/2"-20 Male	4.2 (1.9)	13-3/8 (339)	1-7/8 (48)
13521	1 (744)	1,800	84 dB(A)	34 (952)	5/8"-11 Male	3/8" NPT	1/2"-20 Male	3.8 (1.7)	14-7/8 (378)	1-7/8 (48)
13511	1 (744)	1,800	82 dB(A)	34 (952)	5/8" or 1"	3/8" NPT	N/A	4.6 (2.1)	17-1/4 (438)	1-7/8 (48)
13531	1 (744)	1,800	82 dB(A)	34 (952)	5/8"-11 Male	3/8" NPT	N/A	4.2 (1.9)	17-1/2 (445)	1-7/8 (48)

Tune-Up Kit: No. 96532 • Additional Specifications: Hose I.D. Size 3/8" (10 mm) • Air Pressure 90 PSIG (6.2 Bar)

Dynastraight®

Air-Powered Abrasive Finishing Tool

For Graining, Cleaning and Polishing on Stainless Steel, Aluminum, Carbon Steel, Composites

Model 13201 3,400 RPM, .7 hp

- 13016 Arbor for up to 2" wide x 1/2" I.D. wheels. Any accessory with 1/2" dia. bore may be mounted.

Model 13202 3,400 RPM, .7 hp

- 13017 Arbor for up to 2" wide x 5/8" I.D. wheels. Any accessory with 5/8" dia. bore may be mounted.

Model 13204 3,400 RPM, .7 hp

- 13015 Threaded Arbor (5/8"-11) ideal for use with optional 94472 Dynacushion® Pneumatic Wheel.

Model 13205 3,400 RPM, .7 hp

- 13071 Combo Arbor for up to 3" wide wheels with 5/8" or 1" dia. center hole. Any Dynacushion® pneumatic wheel with 5/8" bore may be mounted (such as 92936).

13220 Versatility Kit

- Includes 13204 Dynastraight; 94472 Dynacushion® Pneumatic Wheel; 98130 Air Chuck (1/4" NPT); 94300 Dynaswivel® (1/4" NPT); 13016 Arbor; assortment of abrasives.

Model 13502 3,400 RPM, 1 hp

- 13016 Arbor for up to 2" wide x 1/2" I.D. wheels. Any accessory with 1/2" dia. bore may be mounted.
- Ideal set-up for optional surface conditioning discs (shown).

Model 13503 3,400 RPM, 1 hp

- 13017 Arbor for up to 2" wide x 5/8" I.D. wheels. Any accessory with 5/8" dia. bore may be mounted.

Arbors

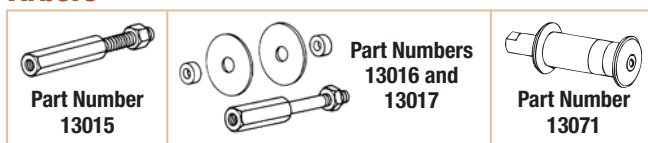

See page 17 for detailed arbor information.

FOR ABRASIVE BELTS, CONDITIONING DISCS, FLAP WHEELS

Up to 8" (203 mm) diameter



Model 13204



See 13204
Dynastraight®
at Work!

13204 Dynastraight® powers optional 94472 Dynacushion® pneumatic wheel on stainless steel.



Slower speed achieves longer and deeper grain pattern in work surface.



Model 13220



Model 13502

Disc Sold Separately

Model Number	Motor hp (W)	Motor RPM	Sound Level	Maximum Air Flow SCFM (L/Min)	Wheel Arbor Diameter	Air Inlet Thread	Tool Thread	Weight Pound (kg)	Length Inch (mm)	Height Inch (mm)
13201	.7 (522)	3,400	82 dB(A)	35 (977)	1/2"	1/4" NPT	1/2"-20 Male	3.9 (1.8)	13-5/8 (346)	1-3/4 (44)
13202	.7 (522)	3,400	82 dB(A)	35 (977)	5/8"	1/4" NPT	1/2"-20 Male	3.9 (1.8)	13-5/8 (346)	1-3/4 (44)
13204	.7 (522)	3,400	82 dB(A)	35 (977)	5/8"-11	1/4" NPT	1/2"-20 Male	3.8 (1.7)	14-5/8 (371)	1-3/4 (44)
13205	.7 (522)	3,400	82 dB(A)	35 (977)	5/8" or 1"	1/4" NPT	1/2"-20 Male	4.0 (1.8)	13-5/8 (346)	1-3/4 (44)
13502	1 (744)	3,400	80 dB(A)	43 (1,218)	1/2"	3/8" NPT	1/2"-20 Male	4.3 (2.0)	15-1/8 (384)	1-7/8 (48)
13503	1 (744)	3,400	80 dB(A)	43 (1,218)	5/8"	3/8" NPT	1/2"-20 Male	4.2 (1.9)	13-7/8 (353)	1-7/8 (48)

Tune-Up Kit: .7 hp Models – No. 96260; 1 hp Models – No. 96532 • Additional Specifications: Hose I.D. Size 3/8" (10 mm) • Air Pressure 90 PSIG (6.2 Bar)

Dynastraight®

Air-Powered Abrasive Finishing Tool

For Graining, Cleaning and Polishing on Stainless Steel, Aluminum, Carbon Steel, Composites

Model 13505 3,400 RPM, 1 hp

- 13015 Threaded Arbor (5/8" -11) ideal for use with optional 94472 Dynacushion® pneumatic wheel (shown).

Model 13506 3,400 RPM, 1 hp

- 13071 Combo Arbor for up to 3" wide wheels with 5/8" or 1" diameter center hole. Any Dynacushion® pneumatic wheel with 5/8" dia. bore (such as 92936) may be mounted.

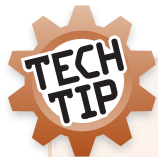

Avoid tipping the pneumatic wheel when operating. Best results will be achieved when keeping the pneumatic wheel as flat on the surface as possible.

RIGHT

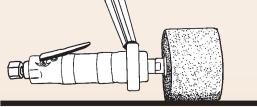

WRONG

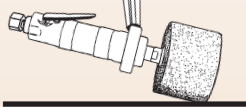

**FOR ABRASIVE BELTS,
CONDITIONING DISCS,
FLAP WHEELS**

Up to 8" (203 mm) diameter



Model
13505

13505 Dynastraight® powers optional 94472 Dynacushion® pneumatic wheel.

Arbors



Part Number 13015

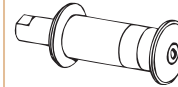

Part Number 13071

See page 17 for detailed arbor information.



**See 13505
Dynastraight®
at Work!**

Model 13512 3,400 RPM, 6" Extension, 1 hp

- 1/2" diameter arbor for up to 2" wide x 1/2" I.D. wheels. Any accessory with 1/2" diameter bore may be mounted.
- Ideal set-up for optional surface conditioning discs (shown).
- Cushioned grip enhances operator comfort.

Model 13515 3,400 RPM, 6" Extension, 1 hp

- Ideal set-up for optional Dynacushion® wheel.
- Includes threaded arbor for exclusive use with up to 3-1/2" wide pneumatic wheels (wheel not included) with threaded 5/8"-11 center hole (such as 94472).
- Cushioned grip enhances operator comfort.

Model 13516 3,400 RPM, 6" Extension, 1 hp

- 13071 Combo Arbor, for up to 3" wide wheels with 5/8" or 1" diameter center hole.
- Any Dynacushion® pneumatic wheel with 5/8" dia. bore (such as 92936) may be mounted.
- Cushioned grip enhances operator comfort.



**See 13515
Dynastraight®
at Work!**



Model
13512

Disc Sold Separately



Model
13515

13515 Dynastraight® sets grain pattern in stainless steel.

Model Number	Motor hp (W)	Motor RPM	Sound Level	Maximum Air Flow SCFM (L/Min)	Wheel Arbor Diameter	Air Inlet Thread	Tool Thread	Weight Pound (kg)	Length Inch (mm)	Height Inch (mm)
13505	1 (744)	3,400	80 dB(A)	43 (1,218)	5/8"-11 Male	3/8" NPT	1/2"-20 Male	4.2 (1.9)	16-1/8 (409)	1-7/8 (48)
13506	1 (744)	3,400	80 dB(A)	43 (1,218)	5/8" or 1"	3/8" NPT	1/2"-20 Male	4.4 (2.0)	14-1/2 (369)	1-7/8 (48)
13512	1 (744)	3,400	80 dB(A)	43 (1,218)	1/2	3/8" NPT	—	4.4 (2.0)	18-1/2 (471)	1-7/8 (48)
13515	1 (744)	3,400	80 dB(A)	43 (1,218)	5/8"-11 Male	3/8" NPT	—	4.1 (1.9)	18-5/8 (472)	1-7/8 (48)
13516	1 (744)	3,400	80 dB(A)	43 (1,218)	5/8" or 1"	3/8" NPT	—	4.7 (2.1)	18-3/4 (475)	1-7/8 (48)

Tune-Up Kit: No. 96532 • Additional Specifications: Hose I.D. Size 3/8" (10 mm) • Air Pressure 90 PSIG (6.2 Bar)

Dynastraight®

Air-Powered Abrasive Finishing Tool

For Graining, Cleaning and Polishing on Stainless Steel, Aluminum, Carbon Steel, Composites

**FOR ABRASIVE BELTS,
CONDITIONING DISCS,
FLAP WHEELS**

Up to 8" (203 mm) diameter

Model 13206 4,500 RPM, .7 hp

- 13016 Arbor for up to 2" wide x 1/2" I.D. wheels.
- Accessories with 1/2" dia. bore (maximum speed of 4,500 RPM) may be mounted.

Model 13207 4,500 RPM, .7 hp

- 13071 Combo Arbor, for up to 3" wide wheels with 5/8" or 1" dia. center hole.
- Accessories with 5/8" dia. bore (maximum speed of 4,500 RPM) may be mounted.

Model 13214 4,500 RPM, .7 hp

- 13072 Threaded Arbor (5/8"-11), ideal for use with optional 92921 DynaWheel (5" dia. x 1" wide). See page 16.



**See 13206
Dynastraight®
at Work!**

Model 13507 4,500 RPM, 1 hp

- 13016 Arbor for up to 2" wide x 1/2" I.D. wheels.

Model 13508 4,500 RPM, 1 hp

- 13071 Combo Arbor for up to 3" wide wheels with 5/8" or 1" dia. center hole.

Model 13523 4,500 RPM, 1 hp

- 13072 Threaded Arbor (5/8"-11) for exclusive use with optional 92867 or 92868 DynaWheel (5" dia. x 1-1/2" wide). See page 16.



**See 13520
Dynastraight®
at Work!**

Model 13517 4,500 RPM, 6" Extension, 1 hp

- 1/2" diameter arbor for up to 2" wide x 1/2" I.D. wheels.

Model 13518 4,500 RPM, 6" Extension, 1 hp

- 13071 Combo Arbor, for up to 3" wide wheels with 5/8" or 1" dia. center hole.

Model 13520 4,500 RPM, 6" Extension, 1 hp

- Threaded arbor for use with up to 3-1/4" dia. pneumatic wheels with threaded 5/8"-11 center hole.
- Cushioned grip enhances comfort (all extension models).

Model
13523

Optional
92867
DynaWheel
on 13523
Dynastraight®,
for concentrated
grinding and fast
material removal.



Model
13207

Wheel Sold
Separately

Arbors

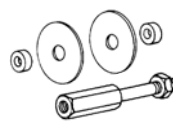

Part Number
13016

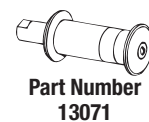

Part Number
13071



Part Number
13072

See page 17 for detailed arbor information.



Model
13518

Models 13517, 13518 and 13520 are ideal for use with optional coated abrasive flap wheels (shown) and non-woven nylon wheels.

Model Number	Motor hp (W)	Motor RPM	Sound Level	Maximum Air Flow SCFM (L/Min)	Wheel Arbor Diameter	Air Inlet Thread	Tool Thread	Weight Pound (kg)	Length Inch (mm)	Height Inch (mm)
13206	.7 (522)	4,500	82 dB(A)	40 (1,133)	1/2"	1/4" NPT	1/2"-20 Male	3.9 (1.8)	13-5/8 (346)	1-3/4 (44)
13207	.7 (522)	4,500	82 dB(A)	40 (1,133)	5/8" or 1"	1/4" NPT	1/2"-20 Male	4.0 (1.8)	13-5/8 (346)	1-3/4 (44)
13214	.7 (522)	4,500	82 dB(A)	40 (1,133)	5/8"-11 Male	1/4" NPT	1/2"-20 Male	4.0 (1.8)	13-5/8 (346)	1-3/4 (44)
13507	1 (744)	4,500	80 dB(A)	41 (1,161)	1/2"	3/8" NPT	1/2"-20 Male	4.3 (2.0)	15-1/8 (384)	1-7/8 (48)
13508	1 (744)	4,500	80 dB(A)	41 (1,161)	5/8" or 1"	3/8" NPT	1/2"-20 Male	4.4 (2.0)	15-1/2 (370)	1-7/8 (48)
13517	1 (744)	4,500	80 dB(A)	41 (1,161)	1/2"	3/8" NPT	—	4.4 (2.0)	18-1/2 (471)	1-7/8 (48)
13518	1 (744)	4,500	80 dB(A)	41 (1,161)	5/8" or 1"	3/8" NPT	—	4.7 (2.1)	18-3/4 (475)	1-7/8 (48)
13520	1 (744)	4,500	80 dB(A)	41 (1,161)	5/8"-11 Male	3/8" NPT	—	4.4 (2.0)	18-5/8 (472)	1-7/8 (48)
13523	1 (744)	4,500	80 dB(A)	41 (1,161)	5/8"-11 Male	3/8" NPT	1/2"-20 Male	4.3 (2.0)	14-1/2 (366)	1-7/8 (48)

Tune-Up Kit: .7 hp Models – No. 96260; 1 hp Models – No. 96532 • Additional Specifications: Hose I.D. Size 3/8" (10 mm) • Air Pressure 90 PSIG (6.2 Bar)

Dynastraight® Kits

Versatility Kits with Finishing Tool and DynaWheel

For Material Removal on Stainless Steel, Aluminum, Carbon Steel, Composites

13215 Versatility Kit

- 13214 Dynastraight® (4,500 RPM), with 13072 Threaded Arbor (5/8"-11).
- 92921 DynaWheel (5" dia. x 1" wide), ideal for heavy-duty applications.
- 89186 Coated Abrasive Belt (60 grit), 1" wide x 15-1/2" long.
- Also includes 98130 Air Chuck, for controlled inflation of hard-to-reach valve assemblies. 1/4" female NPT. (See page 15.)



13535 Versatility Kit

- 13523 Dynastraight® (4,500 RPM), with 13070 Threaded Arbor (5/8"-11).
- 92867 DynaWheel (5" dia. x 1-1/2" wide), ideal for heavy-duty applications.
- Three 89182 Coated Abrasive Belts (60 grit), 1-1/2" wide x 15-1/2" long.
- Also includes 98130 Air Chuck, for controlled inflation of hard-to-reach valve assemblies. 1/4" female NPT. (See page 15.)

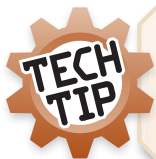

Dynaswivel® air line connector is ideal for use with most air tools. It improves tool maneuverability, minimizes operator fatigue and extends hose life. (See page 18.)



All Kits on page also include 98130 Air Chuck!
(see page 15)



Dynastraight® Kit

Versatility Kits with Finishing Tool and Dynacushion® Wheel

For Material Removal on Stainless Steel, Aluminum, Carbon Steel, Composites

13525 Versatility Kit

- 13505 Dynastraight® (3,400 RPM), with 13015 Threaded Arbor (5/8"-11).
- 94472 Dynacushion® (5" dia. x 3-1/2" wide), ideal for a variety of applications.
- 89173 Coated Abrasive Belt (120 grit), 3-1/2" wide x 15-1/2" long.
- NEW 89174 Coated Abrasive Belt (180 grit), 3-1/2" wide x 15-1/2" long.
- 89242 Non-Woven Nylon Belt (medium), 3-1/2" wide x 15-1/2" long.
- Also includes 98130 Air Chuck, for controlled inflation of hard-to-reach valve assemblies. 1/4" female NPT. (See page 15.)



Dynastraight®

Air-Powered Abrasive Finishing Tool

For Material Removal on Stainless Steel, Aluminum, Carbon Steel, Composites

Model 13509 6,000 RPM, 1 hp

- 13071 Combo Arbor, for up to 3" wide wheels with 5/8" or 1" diameter center hole.
- Ideal for use with optional 94507 Dynacushion® Pneumatic Wheel (3-1/4" dia. x 3" wide x 5/8" bore).

Model 13519 6,000 RPM, 6" Extension, 1 hp

- Threaded arbor for use with up to 3-1/4" diameter pneumatic wheels with threaded 5/8"-11 center hole (such as 94508 Dynacushion®).
- Cushioned grip enhances operator comfort.



See page 17.

See 13509 Dynastraight® at Work!



Model Number	Motor hp (W)	Motor RPM	Sound Level	Maximum Air Flow SCFM (L/Min)	Wheel Arbor Diameter	Air Inlet Thread	Tool Thread	Weight Pound (kg)	Length Inch (mm)	Height Inch (mm)
13509	1 (744)	6,000	82 dB(A)	44 (1,256)	5/8" or 1"	3/8" NPT	1/2"-20 Male	4.3 (2.0)	14-1/2 (369)	1-7/8 (48)
13519	1 (744)	6,000	83 dB(A)	44 (1,256)	5/8"-11 Male	3/8" NPT	N/A	4.4 (2.0)	18-5/8 (472)	1-7/8 (48)

Tune-Up Kit: No. 96532 • Additional Specifications: Hose I.D. Size 3/8" (10 mm) • Air Pressure 90 PSIG (6.2 Bar)

Lightweight Dynastraight®

Air-Powered Abrasive Finishing Tool

Tough, Lightweight Tool for Consistent Finishes

- All models include 13061 Multi-Purpose Arbor for mounting optional abrasive wheels 1/2" to 3" wide (1/2" increments) with 5/8" or 1" center hole.

Model 13100 950 RPM, .4 hp

- Accepts optional accessories with 5/8" bore.
- Also speed-mated for 8" dia. sanding stars. An ideal way to whitewood sand, sealer sand and defuzz.

Model 13101 3,200 RPM, .4 hp

Model 13102 5,000 RPM, .4 hp

- Ideal for 1/2" to 3" wide abrasive impregnated non-woven nylon wheels.
- Achieves smooth finishes on stainless steel and composites used in kitchen and bath industries.
- Mount Abrasive Belts with optional 94507 Dynacushion® Pneumatic Wheel (3-1/4" dia. x 3" wide x 5/8" bore). Models 13101 and 13102 only.

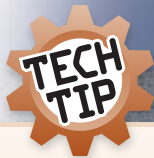

Many Dynastraight® operators find that it is easier to achieve a straight-line pattern by moving the tool in a faster back-and-forth stroke.



See 13102 Lightweight Dynastraight® at Work!

Model 13101

Shown with optional 94507 Dynacushion® pneumatic wheel.

Arbor

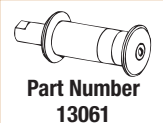

See page 17.

Model Number	Motor hp (W)	Motor RPM	Sound Level	Maximum Air Flow SCFM (L/Min)	Wheel Arbor Diameter	Air Inlet Thread	Tool Thread	Weight Pound (kg)	Length Inch (mm)	Height Inch (mm)
13100	.4 (298)	950	82 dB(A)	22 (623)	5/8" or 1"	1/4" NPT	3/8"-24 Male	2.2 (1.0)	13-1/4 (337)	1-5/8 (40)
13101	.4 (298)	3,200	81 dB(A)	22 (623)	5/8" or 1"	1/4" NPT	3/8"-24 Male	2.2 (1.0)	11-1/2 (292)	1-5/8 (40)
13102	.4 (298)	5,000	84 dB(A)	22 (623)	5/8" or 1"	1/4" NPT	3/8"-24 Male	2.2 (1.0)	11-1/2 (292)	1-5/8 (40)

Tune-Up Kit: No. 96173 • Additional Specifications: Hose I.D. Size 1/4" (6 mm) • Air Pressure 90 PSIG (6.2 Bar)

Dynastraight® Flapper

Air-Powered Abrasive Finishing Tool

FOR ABRASIVE FLAP WHEELS

Up to 3" (76 mm) diameter

*For Polishing Insides of Pipe and Tubing;
Excellent for Light Deburring*

- Remove rust, oxide and scale; clean welds, remove paint and surface condition using abrasive flap wheels.
- Adjustable speed, lever throttle, front exhaust.

Model 51130 18,000 RPM, .5 hp

- Includes 51029 Flap Wheel Adapter.
- Shown with optional Abrasive Flap Wheel, 2-1/2" dia. x 1" wide.

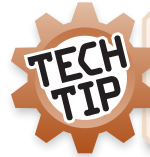

Dynaswivel® air line connector is ideal for use with most air tools. It improves tool maneuverability, minimizes operator fatigue and extends hose life. (See page 18.)



Model 51134

18,000 RPM, 8" Extension, .5 hp

- Includes 51116 Flap Wheel Adapter.
- Shown with optional Abrasive Flap Wheel, 2-1/2" dia. x 1" wide.



IMPORTANT: Speed of tool must not exceed maximum operating speed of accessory. Always wear eye, face and body protection.

Model Number	Motor hp (W)	Motor RPM	Sound Level	Maximum Air Flow SCFM (L/Min)	Hose I.D. Size Inch (mm)	Air Inlet Thread	Adapter Thread	Weight Pound (kg)	Length Inch (mm)	Height Inch (mm)
51130	.5 (373)	18,000	81 dB(A)	30 (850)	3/8 (10)	1/4" NPT	1/4"-20 Female	1.8 (0.8)	7 (178)	1-3/4 (44)
51134	.5 (373)	18,000	75 dB(A)	30 (850)	3/8 (10)	1/4" NPT	1/4"-20 Female	3.4 (1.5)	17-1/8 (435)	1-7/8 (48)

Tune-Up Kit: 51130 – No. 95600, 51134 – No. 96007 • Additional Specifications: Air Pressure 90 PSIG (6.2 Bar)

**HIGHEST
QUALITY!**

**FASTEST
SHIPPING!**



**FREE ON-SITE
DEMOS!**

**BEST
SERVICE!**

Discover The Dynabrade Difference!

Dynabrade.com

Rolling Pin Sander

Air-Powered Abrasive Finishing Tool

For Sanding and Finishing on Contoured Shapes

Model 58050 3,200 RPM, .4 hp

- Unique offset handle to control torque.
- Includes 94434 Pneumatic Wheel, 3-1/4" dia. x 7" long. Wheel inflates to 20 PSI max.
- Designed for use with coated abrasive and non-woven nylon belts.

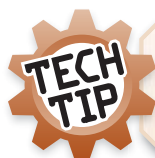

Wheel conforms to wood and metal, and easily inflates/deflates for quick abrasive belt change. Use only 94465 Inflation Tool (see page 14).



FOR ABRASIVE BELTS

7" wide x 10-11/16" long
(178 mm x 271 mm)

Model
58050

Model
58050

Model Number	Motor hp (W)	Motor RPM	Sound Level	Maximum Air Flow SCFM (L/Min)	Hose I.D. Size Inch (mm)	Air Inlet Thread	Tool Thread	Weight Pound (kg)	Length Inch (mm)	Height Inch (mm)
58050	.4 (298)	3,200	82 dB(A)	24 (668)	3/8 (10)	1/4" NPT	5/8"-11 Male	5 (2.3)	17-3/4 (452)	3-1/4 (83)

Tune-Up Kit: No. 96174 • Additional Specifications: Air Pressure 90 PSIG (6.2 Bar)

Mini-Dynisher

Air-Powered Abrasive Finishing Tool

Achieves Superior In-Line Finishes on Metal

- Powers optional Dynacushion® pneumatic wheel. Finish virtually any shape, contour or material, including stainless steel, aluminum, carbon steel, copper, brass, plastic, fiberglass, composites, wood, etc.

Model 13301 950 RPM, .4 hp

- Ideal for use with optional 94507 Dynacushion® pneumatic wheel (3-1/4" dia. x 3" wide).
- Accepts abrasive belts 3" wide x 10-11/16" long.

Model 13300 3,200 RPM, .4 hp

- Ideal for use with optional 94507 Dynacushion® pneumatic wheel (3-1/4" dia. x 3" wide).
- Accepts abrasive belts 3" wide x 10-11/16" long.
- Shroud allows for up to 4-1/2" diameter accessories.

13310 Versatility Kit

- 13300 Mini-Dynisher®; 94507 Dynacushion® pneumatic wheel (3-1/4" dia. x 3" wide); 94465 Wheel Inflation Tool; ceramic coated aluminum oxide belt and medium grade non-woven nylon belt.

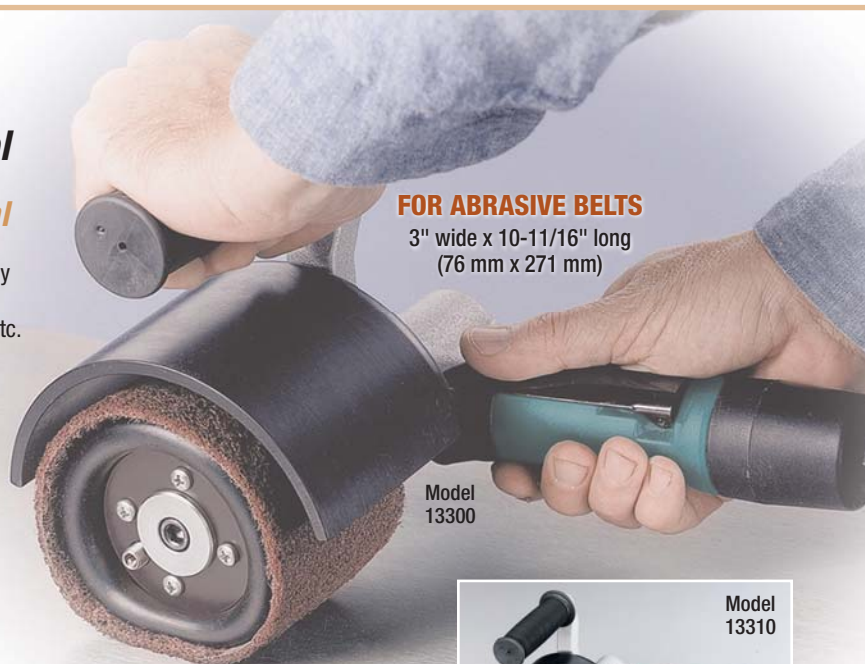

FOR ABRASIVE BELTS

3" wide x 10-11/16" long
(76 mm x 271 mm)

Model
13300

Model
13310

13300 Mini-Dynisher powers optional 94507 Dynacushion® pneumatic wheel on stainless steel.



Model Number	Motor hp (W)	Motor RPM	Sound Level	Maximum Air Flow SCFM (L/Min)	Wheel Arbor Diameter	Hose I.D. Size Inch (mm)	Air Inlet Thread	Weight Pound (kg)	Length Inch (mm)	Height Inch (mm)
13300	.4 (298)	3,200	80 dB(A)	21 (595)	5/8"	1/4 (6)	1/4" NPT	2.8 (1.3)	10 (254)	7 (178)
13301	.4 (298)	950	81 dB(A)	21 (595)	5/8"	1/4 (6)	1/4" NPT	3.4 (1.5)	10 (254)	7 (178)

Tune-Up Kit: No. 96174 • Additional Specifications: Air Pressure 90 PSIG (6.2 Bar)

Dynisher

Air-Powered Abrasive Finishing Tool

Achieves Superior In-Line Finishes on Metal

Model 13400 3,400 RPM, .7 hp

- Excellent for blending and finishing stainless steel and other metals, leaving an in-line scratch pattern.
- Operator uses back-and-forth motion; guard can be adjusted for work right up to side walls.
- Arbor (3/4" dia.) included for mounting a variety of abrasives and accessories.
- Variable speed control and safety-lock lever throttle.
- Ideal for use with optional 92938 Dynacushion® pneumatic wheel (5" dia. x 3-1/2" wide).

13410 Versatility Kit

- Includes 13400 Dynisher with 92938 Dynacushion® pneumatic wheel (5" dia. x 3-1/2" wide), two abrasive belts and 98130 Air Chuck.

Model 13401 3,400 RPM, .7 hp, Metric

- For use with optional 94495 Dynacushion® pneumatic wheel (90 mm x 100 mm wide).

13411 Versatility Kit Metric

- Includes 13401 Dynisher with 94495 Dynacushion® pneumatic wheel (90 mm x 100 mm wide), two abrasive belts and 98130 Air Chuck.



**FOR ABRASIVE BELTS,
CONDITIONING DISCS,
FLAP WHEELS**

Up to 5" (127 mm) diameter



**See 13400
Dynisher
at Work!**

Model 13450 2,800 RPM, 1 hp

- Ideal set-up for optional 92938 Dynacushion® pneumatic wheel (5" dia. x 3-1/2" wide).
- Great for refinishing stainless steel sinks, stainless steel kitchen countertops, etc.
- Slower speed achieves deeper and longer grain pattern in work surface.

13460 Versatility Kit

- Includes Model 13450 Dynisher; 92938 Dynacushion® pneumatic wheel; 98130 Air Chuck; 80-grit belt; medium-grade belt; 95541 Grease Gun; 95542 Grease and 95848 Gear Oil.



**See 13450
Dynisher
at Work!**



13450 Dynisher powers optional 92938 Dynacushion® pneumatic wheel.

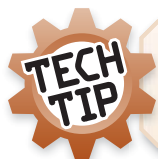

When using pneumatic wheels, inflate wheel only enough to hold the abrasive belt without slippage. Over-inflating the wheel can lead to "chatter marks" on the surface.

Model Number	Motor hp (W)	Motor RPM	Sound Level	Maximum Air Flow SCFM (L/Min)	Wheel Arbor Diameter	Hose I.D. Size Inch (mm)	Air Inlet Thread	Weight Pound (kg)	Length Inch (mm)	Height Inch (mm)
13400	.7 (522)	3,400	84 dB(A)	41 (1,161)	3/4" (19 mm)	3/8 (10)	1/4" NPT	4.5 (2.0)	13-1/2 (343)	9 (229)
13401	.7 (522)	3,400	84 dB(A)	41 (1,161)	3/4" (19 mm)	3/8 (10)	1/4" NPT	4.5 (2.0)	13-1/2 (343)	9 (229)
13450	1 (744)	2,800	80 dB(A)	41 (1,161)	3/4" (19 mm)	3/8 (10)	3/8" NPT	5.7 (2.6)	15 (381)	7 (180)

Tune-Up Kit: .7 hp Models – **No. 96234**; 1 hp Model – **No. 96532** • Additional Specifications: Air Pressure 90 PSIG (6.2 Bar)

Electric Dynisher

Electric-Powered Abrasive Finishing Tool

Achieves Superior In-Line Finishes on Metal

Model 51585 120 V (AC), 3,000 RPM

- Ideal for graining, blending, brushing and polishing. Utilized in a variety of industries, on stainless steel and other metals, as well as plastic, composites and more.
- Variable tool speed of 0-3,000 RPM. Operator can pre-select speed to suit each application.
- Electronic module maintains specified tool speed under load.
- Variable speed trigger allows operator to control speed from 0 to selected setting.
- Operator moves tool in easy front-to-back motion, for achieving in-line scratch pattern. Tool guard is adjustable for most efficient use.
- 5/8"-11 spindle and 3/4" arbor allow mounting of a variety of accessories and abrasives.
- Tool accepts optional Dynacushion® Pneumatic Wheel (5" dia. x 3-1/2" wide) and Non-Woven Nylon Wheels. Great versatility!
- Strong 835-watt power output gets the job done fast!

**FOR ABRASIVE BELTS,
CONDITIONING DISCS,
FLAP WHEELS**

Up to 5" (127 mm) diameter

Model
51585

51585 Electric Dynisher fitted with optional 92937 Dynacushion® Pneumatic Wheel and coated abrasive belt. An ideal setup for achieving in-line scratch pattern on stainless steel.



Model
51585

120 V (AC)

*Wheel Sold
Separately*

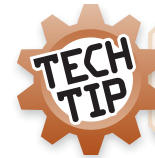

When using pneumatic wheels, inflate wheel only enough to hold the abrasive belt without slippage. Over-inflating the wheel can lead to "chatter marks" on the work surface.

Model Number	Motor RPM	Motor hp (W)	Voltage	Current Amps	Phase	Frequency	Weight Pound (kg)	Length Inch (mm)	Height Inch (mm)
51585	0-3,000	1.8 (1,342)	120 V (AC)	11	1	60 Hz	9.5 (4.31)	17 (432)	8 (203)

NEW Dynabrade ONLINE Programs!

Dynabrade University (DynabradeUniversity.com)

- Video modules presenting Dynabrade product training and vital selling points.
- Ideal for inside and outside sales teams!

Online Repair Program (DynabradeToolRepair.com)

- Step-by-step instruction for the efficient repair of Dynabrade tools.
- Essential resource for in-house service and repair!



Pneumatic Wheels

For Use on Dynastraight® and Dynisher Tools

- When fitted with an abrasive belt and inflated to the desired firmness, our Pneumatic Wheels are ideal for countless grinding and finishing applications.
- Dynabrade Pneumatic Wheels support coated abrasive and non-woven nylon belts for use on metal, wood, plastic, ceramic, fiberglass and composites.

Pneumatic Wheels

Standard Wheels

- For general finishing jobs.
- 1/8" thick natural, 65 durometer rubber.

Heavy Duty Wheels

- When you need a more aggressive wheel for more stock removal.
- 1/4" thick natural, 65 durometer rubber.
- Extremely durable - when used properly wheel is very resistant to gouging.



Wheel Hubs

Composite Hub

- Molded; lightweight design.
- Available with standard construction rubber wheels only.



Heavy Duty Aluminum Hub

- Precision machined for balance run-out and thread quality.
- Easily replace rubber wheel.
- Available with both wheel construction types.



Universal Arbor

- Pneumatic wheels with a universal arbor include three reducer bushings (1/2", 5/8", 3/4") to greatly increase the wheel compatibility.



Inflation Devices and Accessories

Wheel Inflation Tool

Part No. 94465

- Controlled inflation for valve assemblies that are flush with the hub surface.
- 1/4" female NPT.
- 95633 Nozzle replacement available.



Air Pump Assembly

Part No. 98091

- Easy slide pump; no compressor needed.



Dynastraight® Wheel Shields

Part No. 13032

- For wheels up to 8" dia. x 2" wide.
- Built-in handle.



Part No. 13033

- For wheels up to 5" diameter.
- Built-in handle.



Dynacushion® Pneumatic Wheel Kits

Part No. 94478

- Includes: 94473 Dynacushion® Pneumatic Wheel (5" dia. x 3-1/2" wide, composite hub, 3/4" bore), coarse non-woven nylon belt and 80-grit DynaCut Belt.



Part No. 94479

- Includes: 94472 Dynacushion® Pneumatic Wheel (5" dia. x 3-1/2" wide, composite hub, 5/8"-11 thread), coarse non-woven nylon belt and 80-grit DynaCut Belt.

Dynacushion® Pneumatic Wheels

For Polishing and Blending with Dynastraight® and Dynisher Tools

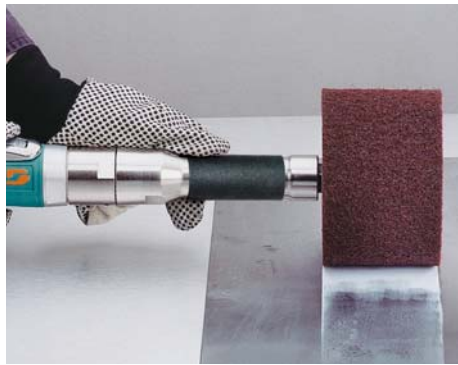

For full information on Dynastraight® and Dynisher tools, please see pages 4-13.

Each Dynacushion® Wheel includes 98130 Low Flow Air Chuck!

- Controlled inflation for hard-to-reach valve assemblies. 1/4" female NPT.



	Dimensions Dia. x W	Part No.	Hub Composition	Arbor Hole	Wheel Part No.	Wheel Type	Belt Size W x L	Max. RPM	Recommended Dynabrade Tools	
	2-1/4" x 3" (57 mm x 76 mm)	92858	Aluminum	1/2"-13 Thread	94433	Standard	3" x 7-3/8" (76 mm x 187 mm)	9,000	Not applicable	
		94432		5/8"-11 Thread					13204, 13505, 13509, 13515, 13519, 13520	
	3" x 2-1/4" (76 mm x 57 mm)	92846	Aluminum	1/2"-13 Thread	92643	Standard	2-1/4" x 9-3/4" (57 mm x 248 mm)	7,000	Not applicable	
		92847		5/8"-11 Thread	92644	Heavy Duty			13204/205/209, 13515/519/520	
		92848		1/2"-13 Thread					Not applicable	
		92849		5/8"-11 Thread					13204/205/209, 13515/519/520	
	3-1/4" x 3" (83 mm x 76 mm)	92824	Aluminum	1/2"-13 Thread	92646	Standard	3" x 10-11/16" (76 mm x 271 mm)	7,000	Not applicable	
		92825		5/8"-11 Thread	92647	Heavy Duty			13204, 13505, 13515, 13520	
		92827		1/2"-13 Thread					Not applicable	
		92828		5/8"-11 Thread	94500	Standard			13204, 13505, 13515, 13520	
		94507*	Composite	5/8" Bore					13101/102, 13202/205/207, 13300/01, 13503/506/508/516/518	
		94508	5/8"-11 Thread	13204, 13505, 13515, 13520						
	90 mm x 100 mm	92863*	Aluminum	19 mm w/ 6 mm Slot	92651	Standard	100 mm x 289 mm	7,000	Not applicable	
	5" x 2-3/4" (127 mm x 70 mm)	92811	Aluminum	5/8"-11 Thread	94482	Standard	2-3/4" x 15-1/2" (70 mm x 394 mm)	3,500	13204, 13505/515/521/531	
		94492	Composite	5/8"-11 Thread					Not applicable	
		92935	Aluminum	Universal 1/2", 5/8" or 3/4" Bore						
		92936	Composite	Universal 1/2", 5/8" or 3/4" Bore						
	5" x 3-1/2" (127 mm x 89 mm)	92801	Aluminum	5/8"-11 Thread	94481	Standard	3-1/2" x 15-1/2" (89 mm x 394 mm)	3,500	13204, 13505, 13515, 13521, 13531	
		94472	Composite		92656	Heavy Duty			Not applicable	
		92805	Composite	5/8"-11 Thread						
		92803	Aluminum	M14 x 2 Thread		94481			Standard	Not applicable
		92937	Aluminum	Universal 1/2", 5/8" or 3/4" Bore						
		92938	Composite	Universal 1/2", 5/8" or 3/4" Bore						

NOTE: Speed of tool must not exceed maximum operating speed of accessory.

*Includes 94465 Inflation Tool (replacing 98130).

DynaWheel Pneumatic Wheels

For Light Grinding and Deburring with Dynastraight® and Dynisher Tools



For full information on Dynastraight® and Dynisher tools, please see pages 4-13.

Each DynaWheel includes 98130 Low Flow Air Chuck!

- Controlled inflation for hard-to-reach valve assemblies. 1/4" female NPT.



	Dimensions Diameter x Width	Part No.	Hub Composition	Arbor Hole	Wheel Part No.	Wheel Type	Belt Size Width x Length	Max. RPM	Recommended Dynabrade Tools
	5" x 1" (127 mm x 25 mm)	92921	Aluminum	5/8"-11 Thread	92908	Heavy Duty	1" x 15-1/2" (25 mm x 394 mm)	4,500	13214, 13523
		92922	Composite	5/8"-11 Thread					
		92923	Aluminum	Universal 1/2", 5/8" or 3/4" Bore					1/2": 13206, 13507
		92924	Composite	Universal 1/2", 5/8" or 3/4" Bore					5/8": 13207, 13508
	5" x 1-1/2" (127 mm x 38 mm)	92867	Aluminum	5/8"-11 Thread	92665	Heavy Duty	1-1/2" x 15-1/2" (38 mm x 394 mm)	4,500	13214, 13523
		92868	Composite	5/8"-11 Thread					
		92928	Aluminum	Universal 1/2", 5/8" or 3/4" Bore					1/2": 13206, 13507
		92929	Composite	Universal 1/2", 5/8" or 3/4" Bore					5/8": 13207, 13508
	5" x 2" (127 mm x 51 mm)	92931	Aluminum	5/8"-11 Thread	92666	Heavy Duty	2" x 15-1/2" (51 mm x 394 mm)	4,500	13214, 13523
		92932	Composite	5/8"-11 Thread					
		92933	Aluminum	Universal 1/2", 5/8" or 3/4" Bore					1/2": 13206, 13507
		92934	Composite	Universal 1/2", 5/8" or 3/4" Bore					5/8": 13207, 13508

NOTE: Speed of tool must not exceed maximum operating speed of accessory.

Arbors

Mount Abrasive Wheels, Discs, Pneumatic Wheels, etc.

Use Dynabrade arbors to mount abrasive wheels, discs, stars and other accessories to male spindle tools

For use with many Dynabrade and other manufacturers' portable tools and bench grinders. Mount abrasive wheels, discs, pneumatic wheels, sanding stars and other accessories to 3/8"-24, 1/2"-20 or 5/8"-11 male spindle tools, by using the combination of spacers and flanges that suits your application.







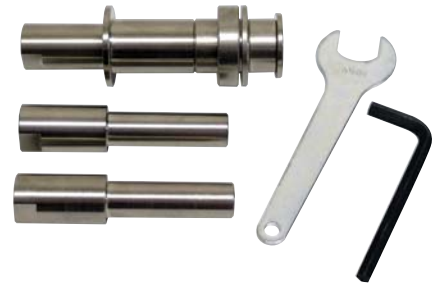



Arbor Kit

Part No. 13074

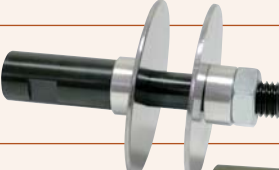
- Mounts to 3/8"-24, 1/2"-20 AND 5/8"-11 male spindle sizes; also accepts any Dynacushion® or accessory with 5/8" bore from 1/2" to 3" wide, in 1/2" increments.



NOTE: Speed of tool must not exceed maximum operating speed of accessory

Tool Spindle	Part Number	Arbor	Arbor Thread	Arbor Bore	Wheel Width
3/8"-24 Male	13061		—	5/8"	Up to 2-1/2"
				1"	
	13074		—	5/8"	Up to 3"
				1"	
1/2"-20 Male	13014		—	14 mm	Up to 51 mm
	13016		—	1/2"	Up to 2"
	13017		—	5/8"	Up to 2"
	13071		—	5/8"	Up to 3"
				1"	
	13074		—	5/8"	Up to 3"
				1"	
	13015		5/8"-11 Male	—	3-1/2"
5/8"-11 Male	13073		—	5/8"	Up to 3"
				1"	
	13074		—	5/8"	Up to 3"
				1"	

Dynaswivel® Air Line Connectors

Never Fight an Air Tool Again! For Use with Most Air Tools

THE PROBLEM



THE SOLUTION



- The Dynaswivel® is a “universal-joint” that connects portable air tools to an air line.
- It improves tool maneuverability, minimizes operator fatigue and extends hose life.
- Patented; works great on air tools or paint guns.

Non-Marring Composite Construction

Double Pivot

- Swivels 360° AT TWO PIVOT POINTS allowing the air hose to drop directly to the floor while providing superb tool handling.

Double Pivot, Flow Control

- Swivels 360° AT TWO PIVOT POINTS allowing the air hose to drop directly to the floor while providing superb tool handling.
- Fingertip air-flow control dial.

Display Pak (96177)

- Includes countertop display box and ten 94300 Dynaswivel® Connectors.

94300



94407

Part Number	Thread Size	Flow Control	Air Flow Range SCFM (L/Min)	Weight oz. (kg)
94300*	1/4" NPT	No	up to 33 (935)	2.15 (.06)
94407**	1/4" NPT	Yes	up to 46 (1,303)	2.40 (.08)

Aluminum and Stainless Steel Construction

Single Pivot

- Right angle “single-pivot” swivels 360° at one location.
- Designed to permit air hose to extend horizontally away from tool while allowing 360° tool maneuverability.
- Great for stationary equipment.

95590



Part Number	Thread Size	Air Flow Range SCFM (L/Min)	Weight lb. (kg)
95590	1/4" NPT	up to 25 (708)	0.11 (0.05)
95591	3/8" NPT	26-45 (736-1,275)	0.26 (0.12)
95592	1/2" NPT	46-65 (1,303-1,841)	0.46 (0.21)

Aluminum and Stainless Steel Construction

Double Pivot

- Swivels 360° AT TWO PIVOT POINTS allowing the air hose to drop directly to the floor while providing superb tool handling.

Double Pivot, Flow Control

- Swivels 360° AT TWO PIVOT POINTS allowing the air hose to drop directly to the floor while providing superb tool handling.
- Finger-tip air-flow control dial.

95460



95734

Part Number	Thread Size	Flow Control	Air Flow Range SCFM (L/Min)	Weight lb. (kg)
95852	1/8" Male x 25 1/4" NPT Female	No	up to 25 (708)	0.18 (0.08)
95460*	1/4" NPT	No	up to 25 (708)	0.20 (0.09)
95734	1/4" NPT	Yes	up to 25 (708)	0.24 (0.11)
95461	3/8" NPT	No	26-45 (736-1,275)	0.40 (0.18)
95462	1/2" NPT	No	46-65 (1,303-1,841)	0.80 (0.36)
95690	3/4" NPT	No	above 65 (1,840)	1.50 (0.68)

Ball-Swivel Plug

Part No. 97016

Plug “swivels” for great tool maneuverability!

- 97016 Ball-Swivel Plug offers 53° conical range of motion, for added tool maneuverability and operator comfort.
- A natural fit with Dynabrade palm-style Random Orbital Sanders!
- Ported plug design allows air flow of up to 74 SCFM (2,095 L/Min).
- Maximum air pressure of 90 PSIG (6.2 Bar).

97016



*USA Government National Stock Number 4730012932930

**USA Government National Stock Number 4730015023159

THE DYNABRADE DIFFERENCE: Weld Removal to Final Finish!

Systems & Solutions on Stainless Steel (300 Series, Flat Work Surface)

Process /Application	Recommended Dynabrade Product	Ra (Average Roughness) and Range of Finish
Weld Removal 	Tool: 52410 Disc Sander Abrasive: 3" Dia. Locking-Type Abrasive Disc, Premium Ceramic, 80 Grit OR Tool: 52634 Disc Sander Abrasive: 4-1/2" Dia. Fiber Disc, Premium Ceramic, 80 Grit	Average: 101.2 Range: 85 - 120 Average: 101.2 Range: 85 - 120
Setting Grain  <i>Pages 5 - 6</i>	Tool: 3,400 RPM Dynastraight® Accessories: 94472 Dynacusion® Wheel, 94465 Wheel Inflation Tool Abrasive: 3-1/2" x 15-1/2" Abrasive Belt, Premium Ceramic, 120 Grit	Average: 77.8 Range: 70 - 90
Blending Stage  <i>Pages 5 - 6</i>	Tool: 3,400 RPM Dynastraight® Accessories: 94472 Dynacusion® Wheel, 94465 Wheel Inflation Tool Abrasive: 3-1/2" x 15-1/2" Abrasive Belt, Medium Non-Woven Nylon	Average: 35.6 Range: 30 - 40 Common range for no. 4 finish (Sanitary food-grade finish)
Final Finish Stage  <i>Page 4</i>	Tool: 1,800 RPM Dynastraight® Accessories: 94472 Dynacusion® Wheel, 94465 Wheel Inflation Tool Abrasive: 3-1/2" x 15-1/2" Abrasive Belt, Very Fine Non-Woven Nylon	Average: 29.8 Range: 25 - 33 Slower-speed Dynastraight® recommended for final finishing stage.

Dynabrade Systems & Solutions

TOOL	ABRASIVE*	ACCESSORIES		
Dynastraight® Model 13204 3,400 RPM, .7 hp Page 5	15-1/2" Long Belts 3-1/2" Width Range of grits available	Arbor 13015 Page 17	Dynacushion® 94472 Page 15	Coupler/Plug Assy. 95685
Dynastraight® Model 13502 3,400 RPM, 1 hp Page 5	6" Dia. DynaStrip Discs 1/2" Center Hole Part no. 78143, Coarse	Arbor Page 17 13016	Coupler/Plug Assy. 98267	Dynaswivel® 95461 Page 18
Extension Dynastraight® Model 13516 3,400 RPM, 1 hp Page 6	15-1/2" Long Belts 2-3/4" Width Range of grits available	Arbor 13071 Page 17	Dynacushion® 92936 Page 15	Dynaswivel® 95461 Page 18
Dynastraight® Model 13214 4,500 RPM, .7 hp Page 7	15-1/2" Long Belts 1-1/2" Width Range of grits available	Arbor 13072 Page 17	DynaWheels 92921, 92867 Page 16	Dynaswivel® 94300 Page 18
Dynisher Model 13450 2,800 RPM, 1 hp Page 12	15-1/2" Long Belts 3-1/2" Width Range of grits available	Gear Oil 95848	Dynacushion® 92938 Page 15	Dynaswivel® 95461 Page 18
Electric Dynisher Model 51585 0-3,000 RPM Page 13	15-1/2" Long Belts 3-1/2" Width Range of grits available	Dynacushion® 92938 Page 15	Handle Assembly 53163	

***Ask About Dynabrade's Complete Line of Abrasives!**



For More Tools and Related Accessories, Visit: Dynabrade.com



DYNABRADE, INC.

8989 Sheridan Drive • Clarence, New York 14031-1419
 Phone: 716-631-0100 • US Fax: 716-631-2073 • International Fax: 716-631-2524
US Consumers Call Toll-Free: 1-800-828-7333
Canadian Consumers Call Toll-Free: 1-800-344-1488

DYNABRADE EUROPE S.à r.l.

Zone Artisanale Op Tomm 6 • L-5485 Wormeldange-Haut, Luxembourg
 Phone: +352 768 494 1 • Fax: +352 768 495

DYNABRADE INDIA ABRASIVE POWER TOOLS Pvt Ltd.

EL-54, TTC Industrial Area, M.I.D.C. Mahape • Electronic Zone, Navi Mumbai - 400705
 Maharashtra, India • Phone: +91 22 2763 2226 • Fax: +91 22 2763 2228

US Consumer Toll-Free Number: 1-888-DYNABRADE

DISTRIBUTED BY:



DYNORBITAL[®] EXTREME

RANDOM ORBITAL SANDER SERIES

NEW! from Dynabrade



EXTREME Power

EXTREME Comfort

EXTREME Performance

WE LISTEN. WE OBSERVE. WE OPTIMIZE.



DYNORBITAL® EXTREME

RANDOM ORBITAL SANDER SERIES

**NEW! from
Dynabrade**



EXTREME sanding in any application from Dynabrade, the premier random orbital solution provider.

Dynabrade proudly introduces our most refined random orbital sander to date. The Dynorbital® Extreme boasts the greatest power and most consistent speed of any palm-style orbital sander. Power and speed combine to quickly and reliably produce the desired finish, while ergonomic features keep operators safe and comfortable throughout their day. Symmetrical design allows left or right-handed operators to work comfortably, while the compact size of the Dynorbital® Extreme fits naturally in most operator's hands.

American-made from the highest grade materials for long-life and high durability.

EXTREME POWER

- New motor design has the highest power-to-weight ratio in the industry, with 0.3 hp at 1.8 lbs.
- Most consistent speed under load in industry, running at 92% of rated tool speed.
- New rotor design enhances power with less friction.

EXTREME COMFORT

- Ergonomic design with integrated comfort platform for more wrist support and overall operator comfort.
- Soft grip co-molded to rigid composite base housing for maximum comfort and durability.
- Recessed throttle lever eliminates pinch and pressure points on an operator's palm.

EXTREME PERFORMANCE

- Achieve consistent, superior finishes in less time.
- Premium sanding pad is weight-mated for the lowest vibration levels.
- Made from the highest quality materials for extreme durability and longevity.





	FEATURE	BENEFIT
1	RECESSED THROTTLE LEVER	<i>Eliminates pressure point on palm</i>
2	INTEGRATED COMFORT PLATFORM	<i>Provides enhanced ergonomic comfort</i>
3	COMFORT GRIP	<i>Tactile, ambidextrous design</i>
4	LIP SEAL SHROUD	<i>Allows excellent vacuum performance</i>
5	WEIGHT-MATED SANDING PAD	<i>For reduced vibration and consistent finishes</i>
6	INTEGRATED SWIVEL CUFF	<i>Secure, maneuverable vacuum connection</i>
7	INCREASED PORT SIZE	<i>For better vacuum capture rate</i>

IDEAL INDUSTRIES



12 MODELS AVAILABLE

Pad Diameter
5" (127 mm) or 6" (152 mm)

Orbit Diameter
3/16" (5 mm) or 3/32" (2.5 mm)

Source Capture
Non-Vacuum or Central Vacuum



3/16" DIA. ORBIT

General Sanding
Teal Throttle Lever



3/32" DIA. ORBIT

Ultra-Fine Sanding
Black Throttle Lever



**LIFETIME
WARRANTY**

TECH TIP

For a swirl-free finish, always start the sander on the work surface and stop the sander off the surface.

Model No.	Diameter	Pad Type	Orbit Dia.	Vacuum Type	RPM	Power	Sound	Max. Air Flow	Weight	Height	Length
X51	5" (127 mm)	PSA	3/16" (5 mm)	Non-Vacuum	12,000	0.3 hp (224 W)	74 dBA	19 SCFM (538 LPM)	1.78 lb (0.8 kg)	3.7" (95 mm)	6.9" (176 mm)
X51H		Hook-Face		Central Vacuum			73 dBA		1.94 lb (0.9 kg)		9.1" (230 mm)
X51V							74 dBA				
X52		PSA	3/32" (2.5 mm)	Non-Vacuum			73 dBA		1.74 lb (0.8 kg)		6.9" (176 mm)
X52H		Hook-Face		Central Vacuum			72 dBA		1.9 lb (0.9 kg)		9.1" (230 mm)
X52V							74 dBA				
X61	6" (152 mm)	PSA	3/16" (5 mm)	Non-Vacuum	12,000	0.3 hp (224 W)	72 dBA	19 SCFM (538 LPM)	1.86 lb (0.8 kg)	3.7" (95 mm)	7.4" (188 mm)
X61H		Hook-Face		Central Vacuum			78 dBA		2.02 lb (0.9 kg)		9.5" (242 mm)
X61V							73 dBA				
X62		PSA	3/32" (2.5 mm)	Non-Vacuum			73 dBA		1.82 lb (0.8 kg)		7.4" (188 mm)
X62H		Hook-Face		Central Vacuum			75 dBA		1.98 lb (0.9 kg)		9.5" (242 mm)
X62V							73 dBA				

Additional Specifications Air Inlet - 1/4" NPT | Air Hose I.D. - 1/4" (6 mm) | Air Pressure - 90 PSIG (6.2 Bar)

For the most current tool specifications, visit dynabrade.com

EXTREME SANDING PADS

PREMIUM URETHANE - MEDIUM DENSITY

Perfectly Weight-Mated for EXTREME Finishes the First Time

	FEATURE	BENEFIT
1	WEIGHT-MATED	For reduced vibration and consistent finishes
2	SINGLE-PIECE HUB	Precise machining reduces pad vibration
3	VACUUM HUB	Direct path for dust/debris extraction
4	MULTI-HOLE PAD	Channels dust/debris to center for best capture



Diameter	Vacuum Type	Holes	Hook-Face	Vinyl-Face	Thickness	Thread
5" (127 mm)	Vacuum	5	54334	—	3/8" (10 mm)	5/16"-24
	Non-Vacuum	—	54325T	56106T		
6" (152 mm)	Vacuum	6	54339	—		
	Non-Vacuum	—	54327T	56107T		

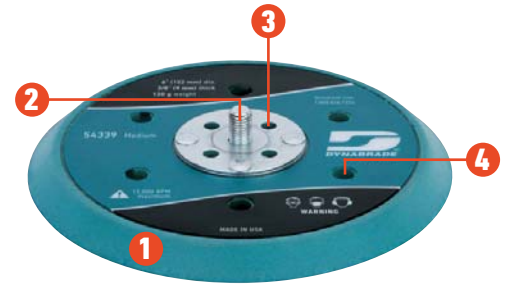

Vacuum
Hook-Face



Non-Vacuum
Hook-Face & PSA

DYNACUT EXTREME ORANGE

PREMIUM FILM ABRASIVE DISCS

EXTREME Orange is the Best Choice for All Materials and Surfaces

	FEATURE	BENEFIT
1	PREMIUM P-GRADE ALUMINUM OXIDE	Aggressive cutting for greater removal and longer life
2	3 MIL FILM BACKING	Durable, flat backing for consistent finishes
3	CLOG-FREE COATING	Resists loading and will not transfer color

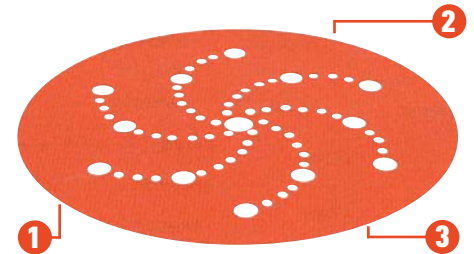

VACUUM HOOK & LOOP DISCS

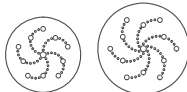

Diameter	Grit	Holes	Part No.	Pkg/Qty
5" (127 mm)	60	51	91535	50
	80		91536	
	100		91537	
	120		91538	
	150		91539	
	180		91540	
	220		91541	
	320		91542	
	400		91543	
6" (152 mm)	60	67	91562	50
	80		91563	
	100		91564	
	120		91565	
	150		91566	
	180		91567	
	220		91568	
	320		91569	
	400		91570	

NON-VACUUM HOOK & LOOP DISCS



Diameter	Grit	Part No.	Pkg/Qty
5" (127 mm)	60	91544	50
	80	91545	
	100	91546	
	120	91547	
	150	91548	
	180	91549	
	220	91550	
	320	91551	
	400	91552	
6" (152 mm)	60	91571	50
	80	91572	
	100	91573	
	120	91574	
	150	91575	
	180	91576	
	220	91577	
	320	91578	
	400	91579	

NON-VACUUM PSA DISCS



Diameter	Grit	Part No.	Pkg/Qty
5" (127 mm)	60	91526	50
	80	91527	
	100	91528	
	120	91529	
	150	91530	
	180	91531	
	220	91532	
	320	91533	
	400	91534	
6" (152 mm)	60	91553	50
	80	91554	
	100	91555	
	120	91556	
	150	91557	
	180	91558	
	220	91559	
	320	91560	
	400	91561	

EXTREME VACUUM SYSTEM

COMPLETE SANDING SOLUTIONS FOR ALL INDUSTRIES

DYNORBITAL® EXTREME

High-performance sanding coupled with best-in-class vacuum pickup



Threaded Swivel Cuff

Prevents vacuum hose from "popping" off.

EXTREME SANDING PAD

All new channel design for use with vacuums and multi-hole abrasives

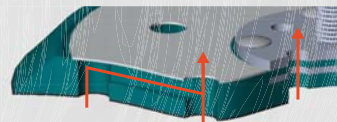

Internal-Channel Vacuum Pad

Dust/debris migrates to pad's center where pick-up is greatest.

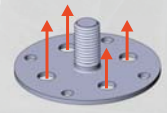

Vacuum Hub

(4) holes for pad center dust/debris extraction.

DYNACUT EXTREME ORANGE

Unique sawtooth spiral vacuum pattern for maximum dust/debris extraction



Sawtooth Spiral

Center hole and positive flow of sawtooth spiral moves dust/debris to center of the disc where vacuum pick-up is greatest.

RAPTOR VAC® VACUUM SYSTEMS

(2) 20' (6 M) coaxial hose with integrated air line, y-inlet, coupler, vacuum hose swivel adapter and (2) disposable bags



Self-Cleaning HEPA Filtration

Automatic filter-blast every 40 seconds ensures optimal particle flow and capture. HEPA filtration keeps your work environment clean and safe.

RAPTOR VAC® VACUUM SYSTEMS

PORTABLE SOURCE CAPTURE SOLUTIONS

Connect with Raptor Vac® Vacuum Systems for EXTREME Capture

Raptor Vac® Vacuum Systems are designed for specific environments and source capture requirements. Each vacuum system is available in pneumatic or electric motor configurations. Division 1 & 2 certified explosion-proof systems are available to safely recover combustible dust.



M-Class



WE LISTEN. WE OBSERVE. WE OPTIMIZE.

EXTREME VACUUM ACCESSORIES

FOR CONNECTION TO ANY VACUUM SETUP



CONDUCTIVE WHIP HOSE

31917 6 Ft (2 M)

- 1" (25 mm) dia. vacuum hose with 31916 Swivel Cuff for attachment to our standard Raptor Vac® 1-1/4" (32 mm) dia. hose
- 5/16" (8 mm) dia. air line with (2) 1/4" male fittings, 1/4" female Mega Flow Plug and protected by a braided hose sleeve



VACUUM HOSE ADAPTOR ASSEMBLY

31935

- 1" (25 mm) direct tool connection to 1-1/4" (32 mm) vacuum hose
- 31916 Swivel Cuff and 1" (25 mm) dia. conductive vacuum hose piece



VACUUM HOSE SWIVEL ADAPTOR

96572 1" (25 mm) to 1" (25 mm)

96573 1" (25 mm) to 1-1/4" (32 mm)

- For slip-fit connection to vacuum hose assembly cuffs

DYNABRADE MAINTENANCE PRODUCTS

FOR OPTIMAL SANDER PERFORMANCE



FILTER-REGULATOR-LUBRICATOR

10690 1/2" NPT

- Max. 106 SCFM (3,002 LPM)
- 3/8" NPT reducer bushings for 3/8" air systems
- Adjustable oil drip rate
- 5 micron filter



DYNABRADE AIR LUBE

95842 1 Pint

- 10W/NR, absorbs up to 10% of its weight in water
- Specifically formulated for Dynabrade air tools



DROP-IN MOTOR

- Quick motor replacement, for "less down time"

Pad Dia.	Orbit Dia.	Part No.
5" (127 mm)	3/16" (5 mm) 3/32" (2.5 mm)	69480 69481
6" (152 mm)	3/16" (5 mm) 3/32" (2.5 mm)	69482 69483



MOTOR TUNE-UP KIT

96576

- Maintain your motor at peak performance
- Includes most wearable parts



SANDER SERIES



**DYNORBITAL®
SUPREME**



**NEW DYNORBITAL®
SILVER SUPREME**



**DYNORBITAL-
SPIRIT®**

**THE FUTURE OF
RANDOM ORBITAL SANDING
IS NOW!**





RANDOM ORBITAL SANDER PROGRAM

Dynabrade soars into the future of Random Orbital Sanding technology with a visionary program of THREE top-quality tool designs! Encompassing the widest variety of palm-style Random Orbital Sanders in the world, Dynabrade's new "D3" Series offers unprecedented versatility to the workplace. Made with pride in the USA, each model addresses specific operator needs, allowing the perfect match for every application!

The choice is yours:

- **Dynorbital® Supreme**
- **NEW Dynorbital® Silver Supreme**
- **Dynorbital-Spirit®**

A UNIVERSE OF APPLICATIONS!

Furniture Fixtures and Moldings • Solid Surface Counter Tops • Custom Kitchen Cabinets • Custom Woodwork • Laminated Products • Metal Finishing Carbon Fiber • Fiberglass Mold Repair on Bath Tubs • Bronze Sculptures Unfinished Wood Products • P.O.P. Displays • Custom Guitars • Architectural Millwork • Finish Sand • Antique Restoration • Case Work • Finish Door and Window Frames • Auto Body Work • Sheet Metal Surface Prep Office Furniture • Hydraulic Tanks and Top Plates Aircraft Panels • Outdoor Signs • Upholstered Furniture White Sanding • Tables and Chairs • Utility Trucks Medical Equipment • Computer Frames • Food Industry Conveyors • Veneer Zinc Castings Window Shutters • Refinish Aircraft Windows Raised Panel Doors • Painted Parts Billiard Tables • Auto Bumper • Fabricated Metal Parts • Edge Sanding • Polish Steel Caps • Aluminum Furniture • Sand Primer Decorative Accessories • Surface Prep Fiberglass Boats • Home Appliances Satellite Antennas • MDF Components • Finish Custom Injection Moldings and Much More!



Dynorbital® Supreme

Setting the Standard for Random Orbital Supremacy!

- The cornerstone of the "D3" Series, Dynorbital® Supreme now sports a distinctive NEW look, signifying many innovations and improvements!
- "D3" advancements include refined ergonomic design, increased vacuum capabilities, aggressive 3/8" (10 mm) orbit and more.
- When operating on work surface, tool maintains highest RPM in the industry!





Dynorbital® Silver Supreme

***Supreme Power Arrives
in Lightweight Package!***

- The NEW tool in our “D3” Series is the ultimate combination of Supreme power and lightweight comfort!
- “D3” innovations include all-steel components, ergonomic tool grip, outstanding vacuum capabilities and more.
- Steel cylinder and end plates stay perfectly aligned, to maximize motor performance!



Dynorbital- Spirit®

***Light-to-Medium Duty Sander
with Dynabrade Quality Built In!***

- Dynabrade's lightest Random Orbital Sander is ideal for vertical and contoured applications, and for operators with smaller hands.
- “D3” improvements include distinctive NEW look, ergonomic tool grip for added comfort, increased vacuum efficiency and new muffler design.
- For light-to-medium duty customers who demand the Dynabrade Difference!





Dynorbital® Supreme

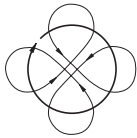

NEW! 3/8"
(10 mm)
Diameter Orbit

For Aggressive Sanding



Look for **ORANGE** Throttle Lever

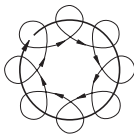

3/16"
(5 mm)
Diameter Orbit

For General Sanding



Look for **SILVER** Throttle Lever



3/32"
(2 mm)
Diameter Orbit

For Ultra-Fine Sanding



Look for **BLACK** Throttle Lever

Non-Vacuum

- Includes low profile, premium urethane weight-mated sanding pad.
- Optional vacuum conversion kits available, to easily convert non-vacuum tool to self-generated vacuum tool or central vacuum tool (see page 11).

NEW!

Pad Diameter Inch (mm)	3/8" Orbit Models	3/16" Orbit Models	3/32" Orbit Models
3-1/2 (89 mm)	56870	56800	56840
5 (127 mm)	56880	56815	56850
6 (152 mm)	56890	56826	56859

Tune-Up Kit: No. 96024



Model
56815

See page 12
for **NEW ORANGE**
Sanding Pads!

Self-Generated Vacuum

- Includes low profile, premium urethane weight-mated sanding pad.
- Ready for connection to optional portable self-contained dust collection system.

NEW!

Pad Diameter Inch (mm)	3/8" Orbit Models	3/16" Orbit Models	3/32" Orbit Models
3-1/2 (89 mm)	56873	56803	56843
5 (127 mm)	56883	56818	56853
6 (152 mm)	56893	56829	56862

Tune-Up Kit: No. 96024



Model
56818

Portable Dust Collection System
(Optional - See Page 16)

Central Vacuum

- Includes low profile, premium urethane weight-mated sanding pad.
- Has 1" outside diameter vacuum port, for easy connection to central vacuum system.

NEW!

Pad Diameter Inch (mm)	3/8" Orbit Models	3/16" Orbit Models	3/32" Orbit Models
3-1/2 (89 mm)	56874	56804	56844
5 (127 mm)	56884	56819	56854
6 (152 mm)	56894	56830	56863

Tune-Up Kit: No. 96024



Model
56819

See page 10 for complete specifications of each Dynorbital® Supreme model.



Supreme Innovations!

The BEST Keeps Getting Better – Dynorbital® Supreme Now Offers “D3” Innovations!

NEW! Refined Ergonomic Tool Grip

Allows more comfortable grip and feel, reducing operator fatigue and increasing efficiency.

Auto-Recess Throttle Lever

Lever recesses into housing grip when depressed, eliminating pressure-point on operator's palm. Lever is color-coded to identify tool orbit (see page 4).

Comfort Platform

(U.S. Patent No. D610,428)

Provides additional hand and wrist support, enhancing operator comfort. Also offers protection against cold air exhaust.



NEW! ONE-HAND Speed Control

New Speed Control dial allows “thumb control” regulating of tool speed. Also reduces accidental contact.

NEW! Low-Vibration Design

Tool grip fully covers tool housing, minimizing vibration transfer to operator.

Perfectly Balanced Sanding Pad

Ask for the ORANGE!

Perfectly-balanced, weight-mated sanding pad with exclusive **single-piece hub design**. Dynabrade premium urethane pads offer smoother operating performance and minimal vibration.

3-1/2" (89 mm) – 80 grams • 5" (127 mm) – 100 grams • 6" (152 mm) – 130 grams

NEW! “Stays-Tight” Threaded Muffler

Muffler cap is now threaded, to remain firmly attached to tool during use.



NEW! 3/8" (10 mm) Orbit

Expanded offering now includes 3/8" dia. orbit models, ideal for heavy stock removal.

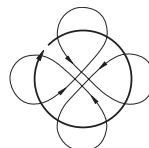

NEW! Enhanced Vacuum Capabilities

Vacuum port diameter is increased by **110%**, allowing maximum capture of dust and debris!

5" (127 mm) Dia. Vacuum Shroud shown.



Patented Bearing Protection

“V-Seal” bearing seal protects balancer shaft bearing from sanding residue, resulting in longer tool life.



Double-Row Angular Contact Bearing



“V-Seal” Bearing Seal



Balancer Shaft



Dynorbital® Silver Supreme

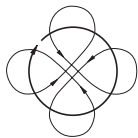

3/8"
(10 mm)
Diameter Orbit

For Aggressive Sanding



Look for **ORANGE** Throttle Lever

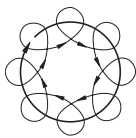

3/16"
(5 mm)
Diameter Orbit

For General Sanding



Look for **GREY** Throttle Lever



3/32"
(2 mm)
Diameter Orbit

For Ultra-Fine Sanding



Look for **BLACK** Throttle Lever

Non-Vacuum

- Includes low profile, premium urethane weight-mated sanding pad.
- Optional vacuum conversion kits available, to easily convert non-vacuum tool to self-generated or central vacuum tool (see page 11).

NEW!

Pad Diameter Inch (mm)	3/8" Orbit Models	3/16" Orbit Models	3/32" Orbit Models
3 (76 mm)	69100	69105	69110
3-1/2 (89 mm)	69000	69015	69030
5 (127 mm)	69005	69020	69035
6 (152 mm)	69010	69025	69040

Tune-Up Kit: No. 96620



Model
69020

See page 12
for **NEW ORANGE**
Sanding Pads!

Self-Generated Vacuum

- Includes low profile, premium urethane weight-mated sanding pad.
- Ready for connection to optional portable self-contained dust collection system.

NEW!

Pad Diameter Inch (mm)	3/8" Orbit Models	3/16" Orbit Models	3/32" Orbit Models
3 (76 mm)	69103	69108	69113
3-1/2 (89 mm)	69003	69018	69033
5 (127 mm)	69008	69023	69038
6 (152 mm)	69013	69028	69043

Tune-Up Kit: No. 96620



Model
69023

Portable Dust Collection System
(Optional - See Page 16)

Central Vacuum

- Includes low profile, premium urethane weight-mated sanding pad.
- Has 1" outside diameter vacuum port, for easy connection to central vacuum system.

NEW!

Pad Diameter Inch (mm)	3/8" Orbit Models	3/16" Orbit Models	3/32" Orbit Models
3 (76 mm)	69104	69109	69114
3-1/2 (89 mm)	69004	69019	69034
5 (127 mm)	69009	69024	69039
6 (152 mm)	69014	69029	69044

Tune-Up Kit: No. 96620



Model
69024

See page 10 for complete specifications of each Dynorbital® Silver Supreme model.



Dynorbital® Silver Supreme

The Most **DURABLE** Random Orbital Sander Ever Built! Combines Supreme Power with Lightweight Comfort!

Compact Grip Size

Compact, ergonomic design is ideal for operators with smaller hands.

Auto-Recess Throttle Lever

Lever recesses into housing grip when depressed, eliminating pressure-point on operator's palm. Lever is made from composite material to insulate against cold air. Lever is color-coded to identify tool orbit (see page 6).

Comfort Platform

(U.S. Patent No. D610,428)

Provides additional hand and wrist support, enhancing operator comfort. Also offers protection against cold air exhaust.

Single-Piece Locking Ring

Allows easier assembly and provides tighter seal.

ONE-HAND Speed Control

New Speed Control dial allows "thumb control" regulating of tool speed. Also reduces accidental contact.

Perfectly Balanced Sanding Pad

Ask for the **ORANGE!**

Perfectly-balanced, weight-mated sanding pad with exclusive **one-piece hub design**. Dynabrade premium urethane pads offer smoother operating performance and minimal vibration.

3" (76 mm) – 75 grams

3-1/2" (89 mm) – 80 grams

5" (127 mm) – 100 grams

6" (152 mm) – 130 grams

Steel Cylinder and End Plates

Steel cylinder and end plates stay perfectly aligned. Design of end plates keeps more air in cylinder, increasing motor efficiency!

NEW! Enhanced Vacuum Capabilities

Vacuum port diameter is increased by **110%**, allowing maximum capture of dust and debris!

3" (76 mm) Dia.
Vacuum Shroud shown.



"Stays-Tight" Threaded Muffler

Muffler cap is now threaded, to remain firmly attached to tool during use.



LIGHTWEIGHT Design

Tool weighs only **1.8 lbs (.8 kg)**! Combines optimum comfort with heavyweight power!

Patented Bearing Protection

"V-Seal" bearing seal protects balancer shaft bearing from sanding residue, resulting in longer tool life.



Double-Row Angular Contact Bearing



"V-Seal" Bearing Seal



Balancer Shaft

"Top Hat" Seal

Protects front motor bearing from sanding residue, and holds in bearing lubrication while keeping out contaminants.



Felt Seal

"Top Hat" Seal



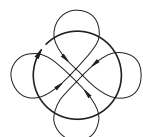

3/8"
(10 mm)
Diameter Orbit

For Aggressive Sanding



Look for **ORANGE** Throttle Lever

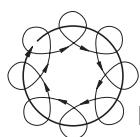

3/16"
(5 mm)
Diameter Orbit

For General Sanding



Look for **GREY** Throttle Lever



3/32"
(2 mm)
Diameter Orbit

For Ultra-Fine Sanding



Look for **BLACK** Throttle Lever

Non-Vacuum

- Includes low profile, premium urethane weight-mated sanding pad.
- Optional vacuum conversion kits available, to easily convert non-vacuum tool to self-generated or central vacuum tool (see page 11).

Pad Diameter Inch (mm)	3/8" Orbit Models	3/16" Orbit Models	3/32" Orbit Models
3 (76 mm)	59100	59105	59110
3-1/2 (89 mm)	59000	59015	59030
5 (127 mm)	59005	59020	59035
6 (152 mm)	59010	59025	59040

Tune-Up Kit: No. 96510



Model
59020

See page 12
for **NEW ORANGE**
Sanding Pads!

Self-Generated Vacuum

- Includes low profile, premium urethane weight-mated sanding pad.
- Model 58054 includes 56320 Pad for Mesh Abrasives (see page 12, 15).
- Ready for connection to optional portable self-contained dust collection system.

Pad Diameter Inch (mm)	3/8" Orbit Models	3/16" Orbit Models	3/32" Orbit Models
3 (76 mm)	59103	59108	59113
3-1/2 (89 mm)	59003	59018	59033
5 (127 mm)	59008	59023/58054	59038
6 (152 mm)	59013	59028	59043

Tune-Up Kit: No. 96510



Model
59023

Portable Dust Collection System
(Optional - See Page 16)

Central Vacuum

- Includes low profile, premium urethane weight-mated sanding pad.
- Has 1" outside diameter vacuum port, for easy connection to central vacuum system.

Pad Diameter Inch (mm)	3/8" Orbit Models	3/16" Orbit Models	3/32" Orbit Models
3 (76 mm)	59104	59109	59114
3-1/2 (89 mm)	59004	59019	59034
5 (127 mm)	59009	59024	59039
6 (152 mm)	59014	59029	59044

Tune-Up Kit: No. 96510



Model
59024

See page 11 for complete specifications of each Dynorbital-Spirit® model.



Light-to-Medium Duty Sander Offers “D3” Advantages!

NEW! Compact Grip Size

Compact, ergonomic design has been reduced in size by **5%**. Ideal for operators with smaller hands, and for use in vertical applications!

NEW! Single-Piece Locking Ring

Allows easier assembly and provides tighter seal.

Perfectly Balanced Sanding Pad

Ask for the ORANGE!

Perfectly-balanced, weight-mated sanding pad with exclusive **one-piece hub design**. Dynabrade premium urethane pads offer smoother operating performance and minimal vibration.

3" (76 mm) – 75 grams

3-1/2" (89 mm) – 80 grams

5" (127 mm) – 100 grams

6" (152 mm) – 130 grams

Auto-Recess Throttle Lever

Lever recesses into housing grip when depressed, eliminating pressure-point on operator's palm. Lever is made from composite material to insulate against cold air. Lever is color-coded to identify tool orbit (see page 8).

Comfort Platform

(U.S. Patent No. D610,428)

Provides additional hand and wrist support, enhancing operator comfort. Also offers protection against cold air exhaust.

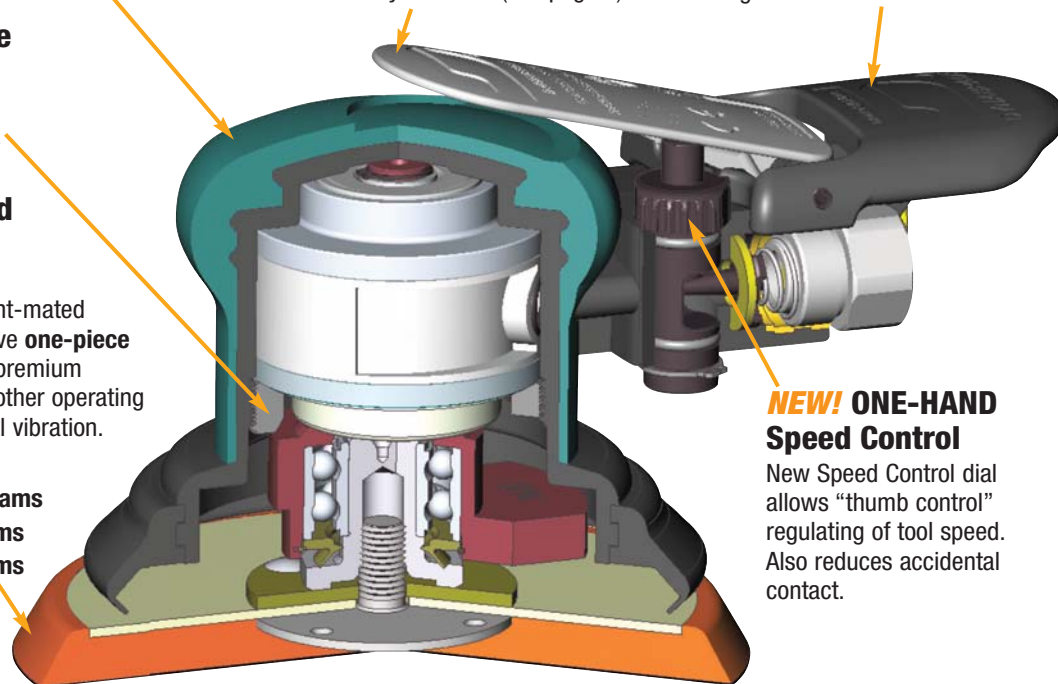

NEW! ONE-HAND Speed Control

New Speed Control dial allows “thumb control” regulating of tool speed. Also reduces accidental contact.

NEW! Enhanced Vacuum Capabilities

Vacuum port diameter is increased by **110%**, allowing maximum capture of dust and debris!



5" (127 mm) Dia.
Vacuum Shroud shown.

NEW! “Stays-Tight” Threaded Muffler

Muffler cap is now threaded, to remain firmly attached to tool during use.



Patented Bearing Protection

“V-Seal” bearing seal protects balancer shaft bearing from sanding residue, resulting in longer tool life.



“Top Hat” Seal

Protects front motor bearing from sanding residue, and holds in bearing lubrication while keeping out contaminants.

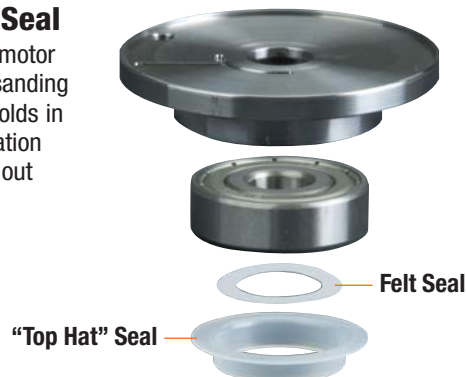



Specification Charts

Dynorbital® Supreme Models *(Pages 4-5)*

Model Number	Vacuum Style	Tool Dia. Inch (mm)	Dia. Orbit Inch (mm)	Sound Level	Weight Pound (kg)	Length Inch (mm)
56800	Non-Vac	3-1/2 (89)	3/16 (5)	77 dB(A)	2.1 (1)	6 (152)
56815	Non-Vac	5 (127)	3/16 (5)	80 dB(A)	2.1 (1)	6-1/2 (165)
56826	Non-Vac	6 (152)	3/16 (5)	78 dB(A)	2.2 (1)	7 (178)
56840	Non-Vac	3-1/2 (89)	3/32 (2.5)	76 dB(A)	2.1 (1)	6 (152)
56850	Non-Vac	5 (127)	3/32 (2.5)	77 dB(A)	2.1 (1)	6-1/2 (165)
56859	Non-Vac	6 (152)	3/32 (2.5)	76 dB(A)	2.2 (1)	7 (178)
56870	Non-Vac	3-1/2 (89)	3/8 (10)	80 dB(A)	2.2 (1)	6 (152)
56880	Non-Vac	5 (127)	3/8 (10)	78 dB(A)	2.3 (1)	6-1/2 (165)
56890	Non-Vac	6 (152)	3/8 (10)	80 dB(A)	2.4 (1)	7 (178)
56803	Self-Gen	3-1/2 (89)	3/16 (5)	84 dB(A)	2.1 (1)	8-1/4 (210)
56818	Self-Gen	5 (127)	3/16 (5)	82 dB(A)	2.1 (1)	8-1/2 (216)
56829	Self-Gen	6 (152)	3/16 (5)	85 dB(A)	2.3 (1)	9 (229)
56843	Self-Gen	3-1/2 (89)	3/32 (2.5)	81 dB(A)	2.1 (1)	8-1/4 (210)
56853	Self-Gen	5 (127)	3/32 (2.5)	83 dB(A)	2.1 (1)	8-1/2 (216)

Model Number	Vacuum Style	Tool Dia. Inch (mm)	Dia. Orbit Inch (mm)	Sound Level	Weight Pound (kg)	Length Inch (mm)
56862	Self-Gen	6 (152)	3/32 (2.5)	84 dB(A)	2.3 (1)	9 (229)
56873	Self-Gen	3-1/2 (89)	3/8 (10)	84 dB(A)	2.3 (1)	8-1/4 (210)
56883	Self-Gen	5 (127)	3/8 (10)	85 dB(A)	2.3 (1)	8-1/2 (216)
56893	Self-Gen	6 (152)	3/8 (10)	85 dB(A)	2.5 (1.1)	9 (229)
56804	Central	3-1/2 (89)	3/16 (5)	79 dB(A)	2.1 (1)	7 (178)
56819	Central	5 (127)	3/16 (5)	80 dB(A)	2.2 (1)	7-1/4 (184)
56830	Central	6 (152)	3/16 (5)	81 dB(A)	2.3 (1)	7-3/4 (197)
56844	Central	3-1/2 (89)	3/32 (2.5)	79 dB(A)	2.1 (1)	7 (178)
56854	Central	5 (127)	3/32 (2.5)	80 dB(A)	2.2 (1)	7-1/4 (184)
56863	Central	6 (152)	3/32 (2.5)	79 dB(A)	2.3 (1)	7-3/4 (197)
56874	Central	3-1/2 (89)	3/8 (10)	80 dB(A)	2.3 (1)	7 (178)
56884	Central	5 (127)	3/8 (10)	81 dB(A)	2.3 (1)	7-1/4 (184)
56894	Central	6 (152)	3/8 (10)	84 dB(A)	2.4 (1)	7-3/4 (197)

Additional Specifications: Motor .28 hp (209 W) • Motor 12,000 RPM • Pad Thread 5/16"-24 Male • Air Inlet Thread 1/4" NPT
Hose I.D. Size 1/4" (6 mm) • Air Flow Rate 18 SCFM/510 L/Min • Height 3-1/2" (89 mm) • Air Pressure 90 PSIG (6.2 Bar)
Sound Level is the pressure measurement according to the method outlined in ISO regulation ISO-15744



Dynorbital® Silver Supreme Models *(Pages 6-7)*

Model Number	Vacuum Style	Tool Dia. Inch (mm)	Dia. Orbit Inch (mm)	Sound Level	Weight Pound (kg)	Length Inch (mm)
69000	Non-Vac	3-1/2 (89)	3/8 (10)	76 dB(A)	1.8 (.8)	6 (152)
69005	Non-Vac	5 (127)	3/8 (10)	80 dB(A)	1.9 (.9)	6-1/2 (165)
69010	Non-Vac	6 (152)	3/8 (10)	83 dB(A)	1.9 (.9)	7 (178)
69015	Non-Vac	3-1/2 (89)	3/16 (5)	77 dB(A)	1.7 (.8)	6 (152)
69020	Non-Vac	5 (127)	3/16 (5)	77 dB(A)	1.8 (.8)	6-1/2 (165)
69025	Non-Vac	6 (152)	3/16 (5)	77 dB(A)	1.8 (.8)	7 (178)
69030	Non-Vac	3-1/2 (89)	3/32 (2.5)	75 dB(A)	1.7 (.8)	6 (152)
69035	Non-Vac	5 (127)	3/32 (2.5)	78 dB(A)	1.7 (.8)	6-1/2 (165)
69040	Non-Vac	6 (152)	3/32 (2.5)	78 dB(A)	1.8 (.8)	7 (178)
69100	Non-Vac	3 (76)	3/8 (10)	80 dB(A)	1.8 (.8)	6 (152)
69105	Non-Vac	3 (76)	3/16 (5)	80 dB(A)	1.7 (.8)	6-1/2 (165)
69110	Non-Vac	3 (76)	3/32 (2.5)	80 dB(A)	1.7 (.8)	7 (178)
69003	Self-Gen	3-1/2 (89)	3/8 (10)	84 dB(A)	1.9 (.9)	8-1/2 (216)
69008	Self-Gen	5 (127)	3/8 (10)	80 dB(A)	2.0 (.9)	8-1/2 (216)
69013	Self-Gen	6 (152)	3/8 (10)	80 dB(A)	2.1 (.9)	9 (229)
69018	Self-Gen	3-1/2 (89)	3/16 (5)	79 dB(A)	1.8 (.8)	8-1/2 (216)
69023	Self-Gen	5 (127)	3/16 (5)	81 dB(A)	1.9 (.9)	8-1/2 (216)
69028	Self-Gen	6 (152)	3/16 (5)	84 dB(A)	2.0 (.9)	9 (229)

Model Number	Vacuum Style	Tool Dia. Inch (mm)	Dia. Orbit Inch (mm)	Sound Level	Weight Pound (kg)	Length Inch (mm)
69033	Self-Gen	3-1/2 (89)	3/32 (2.5)	84 dB(A)	1.8 (.8)	8-1/2 (216)
69038	Self-Gen	5 (127)	3/32 (2.5)	84 dB(A)	1.9 (.9)	8-1/2 (216)
69043	Self-Gen	6 (152)	3/32 (2.5)	81 dB(A)	2.0 (.9)	9 (229)
69103	Self-Gen	3 (76)	3/8 (10)	81 dB(A)	1.9 (.9)	8-1/2 (216)
69108	Self-Gen	3 (76)	3/16 (5)	79 dB(A)	1.8 (.8)	8-1/2 (216)
69113	Self-Gen	3 (76)	3/32 (2.5)	83 dB(A)	1.8 (.8)	9 (229)
69004	Central	3-1/2 (89)	3/8 (10)	79 dB(A)	1.9 (.9)	7 (178)
69009	Central	5 (127)	3/8 (10)	80 dB(A)	2.0 (.9)	7-1/4 (184)
69014	Central	6 (152)	3/8 (10)	84 dB(A)	1.9 (.9)	7-3/4 (197)
69019	Central	3-1/2 (89)	3/16 (5)	83 dB(A)	1.8 (.8)	7 (178)
69024	Central	5 (127)	3/16 (5)	79 dB(A)	1.9 (.9)	7-1/4 (184)
69029	Central	6 (152)	3/16 (5)	83 dB(A)	2.0 (.9)	7-3/4 (197)
69034	Central	3-1/2 (89)	3/32 (2.5)	82 dB(A)	1.8 (.8)	7 (178)
69039	Central	5 (127)	3/32 (2.5)	81 dB(A)	1.8 (.8)	7-1/4 (184)
69044	Central	6 (152)	3/32 (2.5)	82 dB(A)	2.0 (.9)	7-3/4 (197)
69104	Central	3 (76)	3/8 (10)	82 dB(A)	1.9 (.9)	7 (178)
69109	Central	3 (76)	3/16 (5)	80 dB(A)	1.8 (.8)	7-1/4 (184)
69114	Central	3 (76)	3/32 (2.5)	82 dB(A)	1.8 (.8)	7-3/4 (197)

Additional Specifications: Motor .26 hp (194 W) • Motor 12,000 RPM • Pad Thread 5/16"-24 Male • Air Inlet Thread 1/4" NPT
Hose I.D. Size 1/4" (6 mm) • Air Flow Rate 16 SCFM/450 L/Min • Height 3-1/2" (89 mm) • Air Pressure 90 PSIG (6.2 Bar)
Sound Level is the pressure measurement according to the method outlined in ISO regulation ISO-15744





Specification Charts

Dynorbital-Spirit® Models (Pages 8-9)

Model Number	Vacuum Style	Tool Dia. Inch (mm)	Dia. Orbit Inch (mm)	Sound Level	Weight Pound (kg)	Length Inch (mm)
59000	Non-Vac	3-1/2 (89)	3/8 (10)	79 dB(A)	1.4 (.6)	6 (152)
59005	Non-Vac	5 (127)	3/8 (10)	82 dB(A)	1.5 (.7)	6-1/2 (165)
59010	Non-Vac	6 (152)	3/8 (10)	82 dB(A)	1.6 (.7)	7 (178)
59015	Non-Vac	3-1/2 (89)	3/16 (5)	81 dB(A)	1.4 (.6)	6 (152)
59020	Non-Vac	5 (127)	3/16 (5)	80 dB(A)	1.4 (.6)	6-1/2 (165)
59025	Non-Vac	6 (152)	3/16 (5)	81 dB(A)	1.5 (.7)	7 (178)
59030	Non-Vac	3-1/2 (89)	3/32 (2.5)	81 dB(A)	1.4 (.6)	6 (152)
59035	Non-Vac	5 (127)	3/32 (2.5)	80 dB(A)	1.4 (.6)	6-1/2 (165)
59040	Non-Vac	6 (152)	3/32 (2.5)	81 dB(A)	1.5 (.6)	7 (178)
59100	Non-Vac	3 (76)	3/8 (10)	79 dB(A)	1.4 (.6)	6 (152)
59105	Non-Vac	3 (76)	3/16 (5)	81 dB(A)	1.4 (.6)	6-1/2 (165)
59110	Non-Vac	3 (76)	3/32 (2.5)	79 dB(A)	1.3 (.6)	7 (178)
59003	Self-Gen	3-1/2 (89)	3/8 (10)	88 dB(A)	1.5 (.7)	8-1/2 (216)
59008	Self-Gen	5 (127)	3/8 (10)	87 dB(A)	1.6 (.7)	8-1/2 (216)
59013	Self-Gen	6 (152)	3/8 (10)	87 dB(A)	1.7 (.7)	9 (229)
59018	Self-Gen	3-1/2 (89)	3/16 (5)	89 dB(A)	1.4 (.6)	8-1/2 (216)
59023	Self-Gen	5 (127)	3/16 (5)	86 dB(A)	1.5 (.7)	8-1/2 (216)
59028	Self-Gen	6 (152)	3/16 (5)	87 dB(A)	1.6 (.7)	9 (229)

Model Number	Vacuum Style	Tool Dia. Inch (mm)	Dia. Orbit Inch (mm)	Sound Level	Weight Pound (kg)	Length Inch (mm)
59033	Self-Gen	3-1/2 (89)	3/32 (2.5)	88 dB(A)	1.4 (.6)	8-1/2 (216)
59038	Self-Gen	5 (127)	3/32 (2.5)	86 dB(A)	1.5 (.6)	8-1/2 (216)
59043	Self-Gen	6 (152)	3/32 (2.5)	87 dB(A)	1.5 (.7)	9 (229)
59103	Self-Gen	3 (76)	3/8 (10)	88 dB(A)	1.5 (.7)	8-1/2 (216)
59108	Self-Gen	3 (76)	3/16 (5)	89 dB(A)	1.4 (.6)	8-1/2 (216)
59113	Self-Gen	3 (76)	3/32 (2.5)	88 dB(A)	1.4 (.6)	9 (229)
59004	Central	3-1/2 (89)	3/8 (10)	79 dB(A)	1.5 (.7)	7 (178)
59009	Central	5 (127)	3/8 (10)	83 dB(A)	1.5 (.7)	7-1/4 (184)
59014	Central	6 (152)	3/8 (10)	84 dB(A)	1.6 (.7)	7-3/4 (197)
59019	Central	3-1/2 (89)	3/16 (5)	81 dB(A)	1.4 (.6)	7 (178)
59024	Central	5 (127)	3/16 (5)	81 dB(A)	1.5 (.6)	7-1/4 (184)
59029	Central	6 (152)	3/16 (5)	83 dB(A)	1.6 (.7)	7-3/4 (197)
59034	Central	3-1/2 (89)	3/32 (2.5)	80 dB(A)	1.4 (.6)	7 (178)
59039	Central	5 (127)	3/32 (2.5)	81 dB(A)	1.4 (.6)	7-1/4 (184)
59044	Central	6 (152)	3/32 (2.5)	82 dB(A)	1.5 (.7)	7-3/4 (197)
59104	Central	3 (76)	3/8 (10)	79 dB(A)	1.5 (.6)	7 (178)
59109	Central	3 (76)	3/16 (5)	81 dB(A)	1.4 (.6)	7-1/4 (184)
59114	Central	3 (76)	3/32 (2.5)	81 dB(A)	1.4 (.6)	7-3/4 (197)

Additional Specifications: Motor .25 hp (186 W) • Motor 12,000 RPM • Pad Thread 5/16"-24 Male • Air Inlet Thread 1/4" NPT
Hose I.D. Size 1/4" (6 mm) • Air Flow Rate 14 SCFM/396 L/Min • Height 3-1/2" (89 mm) • Air Pressure 90 PSIG (6.2 Bar)
Sound Level is the pressure measurement according to the method outlined in ISO regulation ISO-15744

Drop-In Motors

- Allows quick and easy replacement.
- No motor adjustments needed.
- Repair time reduced by 90%!
- Follow maintenance procedures as described in tool's parts page.



Drop-In Motor for Dynorbital® Silver Supreme Sanders

Drop-In Motor for Dynorbital-Spirit® Sanders

Dynorbital® Silver Supreme

3" (76 mm) Dia. Models	3/8" Orbit Part No.	3/16" Orbit Part No.	3/32" Orbit Part No.
Single Motor	69450	69451	69452
Ten Pack	69467	69468	69469

3-1/2" (89 mm) Dia. Models	3/8" Orbit Part No.	3/16" Orbit Part No.	3/32" Orbit Part No.
Single Motor	69453	69454	69455
Ten Pack	69470	69471	69472

5" (127 mm) Dia. Models	3/8" Orbit Part No.	3/16" Orbit Part No.	3/32" Orbit Part No.
Single Motor	69456	69457	69458
Ten Pack	69473	69474	69475

6" (152 mm) Dia. Models	3/8" Orbit Part No.	3/16" Orbit Part No.	3/32" Orbit Part No.
Single Motor	69459	69460	69461
Ten Pack	69476	69477	69478

Dynorbital-Spirit®

3" (76 mm) & 3-1/2" (89 mm)	3/8" Orbit Part No.	3/16" Orbit Part No.	3/32" Orbit Part No.
Single Motor	59450	59451	59452
Ten Pack	59470	59471	59472
Ten Pack w/Repair Tools	59460	59461	59462

5" (127 mm) Dia. Models	3/8" Orbit Part No.	3/16" Orbit Part No.	3/32" Orbit Part No.
Single Motor	59453	59454	59455
Ten Pack	59473	59474	59475
Ten Pack w/Repair Tools	59463	59464	59465

6" (152 mm) Dia. Models	3/8" Orbit Part No.	3/16" Orbit Part No.	3/32" Orbit Part No.
Single Motor	59456	59457	59458
Ten Pack	59476	59477	59478
Ten Pack w/Repair Tools	59466	59467	59468

Vacuum Conversion Kits

- For use with Dynabrade "D3" Series Random Orbital Sanders.
- Pad diameter determines which kit is right for your tool.
- Conversion kit allows user to change tool into desired vacuum configuration.



Pad Diameter Inch (mm)	Converts Tool To	Kit Part Number
3-1/2 (89 mm)	Self-Generated Vac	57118
3-1/2 (89 mm)	Central Vacuum	57119
5 (127 mm)	Self-Generated Vac	57120
5 (127 mm)	Central Vacuum	57121
6 (152 mm)	Self-Generated Vac	57122
6 (152 mm)	Central Vacuum	57123

With Dynabrade's Exclusive Single-Piece Hub Design!

- Exclusive single-piece hub design reduces pad vibration and ensures smooth performance.
- PREMIUM URETHANE Sanding Pads are perfectly weight-mated to Dynabrade tools, for achieving consistent **swirl-free finishes**.

Ask for the ORANGE!

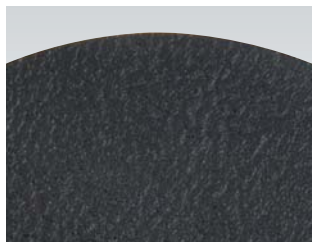

Vinyl-Face Pads

Ideal for PSA-type disc adhesion. Remove abrasive adhesive paper liner and press abrasive to vinyl-face sanding pad. Quick disc removal.



Non-Vacuum Pads

High quality backup pad. Weight-mated for smooth running and minimal tool vibration.



Vacuum Pads

Holes are precisely located to achieve proper alignment with abrasive discs for optimum vacuum capabilities.

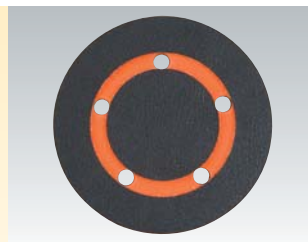

Channel Vacuum Pads

1/8" (3 mm) deep recessed channel. No need to align vacuum holes to pad holes!

Non-Vacuum Pads

Pad Diameter	Part Number	Thickness	Density
3" (76 mm)*	56084	5/8" (16 mm)	Medium
	56086	5/8" (16 mm)	Soft
3-1/2" (89 mm)*	56097	5/8" (16 mm)	Soft
	56098	5/8" (16 mm)	Medium
5" (127 mm)	56102	3/8" (10 mm)	Soft
	56106	3/8" (10 mm)	Medium
	56175	5/8" (16 mm)	Medium
	56185	5/8" (16 mm)	Soft
	56273	1/2" (13 mm)	Extra Soft
6" (152 mm)	56103	3/8" (10 mm)	Soft
	56107	3/8" (10 mm)	Medium
	56177	5/8" (16 mm)	Medium
	56187	5/8" (16 mm)	Soft

All Pads: 13,000 RPM maximum operating speed; 5/16"-24 male thread.

***NOTE:** Our 3" (76 mm) and 3-1/2" (89 mm) pads, without holes, can also be used for vacuum sanding. Vacuum pick-up is around periphery of pad.

Vacuum Pads

Pad Diameter	Part Number	Holes	Thickness	Density
3" (76 mm)*	56084	0	5/8" (16 mm)	Medium
	56086	0	5/8" (16 mm)	Soft
3-1/2" (89 mm)*	56097	0	5/8" (16 mm)	Soft
	56098	0	5/8" (16 mm)	Medium
5" (127 mm)	56100	5	3/8" (10 mm)	Soft
	56104	5	3/8" (10 mm)	Medium
	56176	5	5/8" (16 mm)	Medium
	56186	5	5/8" (16 mm)	Soft
	56241	6	3/8" (10 mm)	Medium
	56274	5	1/2" (13 mm)	Extra Soft
6" (152 mm)	56101	6	3/8" (10 mm)	Soft
	56105	6	3/8" (10 mm)	Medium
	56178	6	5/8" (16 mm)	Medium
	56188	6	5/8" (16 mm)	Soft

All Pads: 13,000 RPM maximum operating speed; 5/16"-24 male thread.

***NOTE:** Our 3" (76 mm) and 3-1/2" (89 mm) pads, without holes, can also be used for vacuum sanding. Vacuum pick-up is around periphery of pad.

Dynabrade's Exclusive Single-Piece Hub Design

- All Dynabrade Sanding Pads feature our exclusive single-piece hub design, which reduces pad vibration and ensures smooth performance!
- Competitive pads have a hub assembled from three separate pieces, which can contribute to pad "wobbling" and uneven sanding - meaning lost time and lost profits!
- "Face Run-Out" of Dynabrade Pads measures only .002 - .005. Competitive pads measure as high as .015 - .040!



Channel Vacuum Pads

Pad Diameter	Part Number	Holes	Thickness	Density
5" (127 mm)	56251	5	3/8" (10 mm)	Soft
	56252	5	3/8" (10 mm)	Medium
	56254	5	5/8" (16 mm)	Medium
	56256	5	5/8" (16 mm)	Soft
6" (152 mm)	56261	6	3/8" (10 mm)	Soft
	56262	6	3/8" (10 mm)	Medium
	56264	6	5/8" (16 mm)	Medium
	56266	6	5/8" (16 mm)	Soft

Hook-Face

Random Orbital Sanding Pads

With Dynabrade's Exclusive Single-Piece Hub Design!

- Exclusive single-piece hub design reduces pad vibration and ensures smooth performance.
- PREMIUM URETHANE Sanding Pads are perfectly weight-mated to Dynabrade tools, for achieving consistent **swirl-free finishes**.

**Ask for the
ORANGE!**

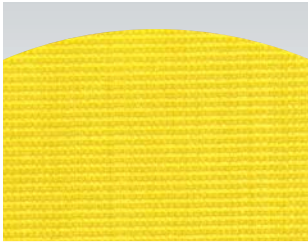

Hook-Face Pads

Short nap pads for use with reattachable discs.

Long nap pads for use with non-woven nylon discs.

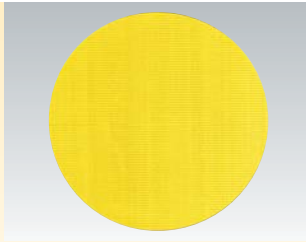

Non-Vacuum Pads

High quality backup pad. Weight-mated for smooth running and minimal tool vibration.

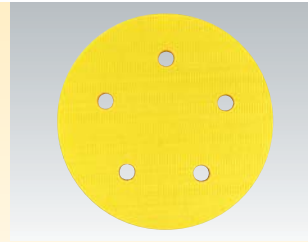

Vacuum Pads

Holes are precisely located to achieve proper alignment with abrasive discs for optimum vacuum capabilities.

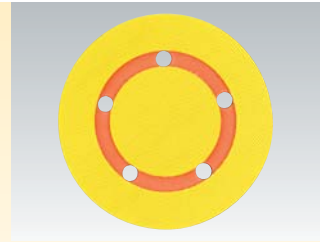

Channel Vacuum Pads

1/8" (3 mm) deep recessed channel. No need to align vacuum holes to pad holes!

Non-Vacuum Pads

Pad Diameter	Part Number	Thickness	Nap	Density
3" (76 mm)*	56087	5/8" (16 mm)	Short	Medium
	56090	5/8" (16 mm)	Long	Medium
	56145	1/2" (13 mm)	Short	Medium
3-1/2" (89 mm)*	54311	5/8" (16 mm)	Short	Soft
	54313	5/8" (16 mm)	Short	Hard
	54314	5/8" (16 mm)	Long	Medium
5" (127 mm)	54325	3/8" (10 mm)	Short	Medium
	56157	3/8" (10 mm)	Short	Soft
	56180	5/8" (16 mm)	Short	Medium
	56195	5/8" (16 mm)	Short	Soft
6" (152 mm)	54327	3/8" (10 mm)	Short	Medium
	56158	3/8" (10 mm)	Short	Soft
	56182	5/8" (16 mm)	Short	Medium
	56197	5/8" (16 mm)	Short	Soft

All Pads: 13,000 RPM maximum operating speed; 5/16"-24 male thread.

***NOTE:** Our 3" (76 mm) and 3-1/2" (89 mm) pads, without holes, can also be used for vacuum sanding. Vacuum pick-up is around periphery of pad.

6-Hole Vacuum Pad

Pad Diameter	Part Number	Holes	Thickness	Nap	Density
3" (76 mm)	56142	6	3/8" (10 mm)	Short	Medium

15-Hole Vacuum Pad*

Pad Diameter	Part Number	Holes	Thickness	Nap	Density
6" (152 mm)	54331	15	5/8" (16 mm)	Short	Medium
6" (152 mm)	56297	15	3/8" (10 mm)	Short	Medium

***NOTE:** This pad has unique "8+6+1" hole pattern.

It accepts 6" (152 mm) diameter abrasive discs with these hole patterns:

- 6-Hole • 6+1 • 8+1 • 8+6+1 • 21-Hole • Mesh or Multi-Hole

Vacuum Pads

Pad Diameter	Part Number	Holes	Thickness	Nap	Density
3" (76 mm)*	56087	0	5/8" (16 mm)	Short	Medium
	56090	0	5/8" (16 mm)	Long	Medium
	56144	3	1/2" (13 mm)	Short	Medium
3-1/2" (89 mm)*	54311	0	5/8" (16 mm)	Short	Soft
	54313	0	5/8" (16 mm)	Short	Hard
	54314	0	5/8" (16 mm)	Long	Medium
5" (127 mm)	54326	5	3/8" (10 mm)	Short	Medium
	56155	5	3/8" (10 mm)	Short	Soft
	56181	5	5/8" (16 mm)	Short	Medium
	56196	5	5/8" (16 mm)	Short	Soft
	56240	6	3/8" (10 mm)	Short	Medium
	56320	44	3/8" (10 mm)	Short	Medium
6" (152 mm)	54328	6	3/8" (10 mm)	Short	Medium
	56156	6	3/8" (10 mm)	Short	Soft
	56183	6	5/8" (16 mm)	Short	Medium
	56198	6	5/8" (16 mm)	Short	Soft
	56321	52	3/8" (10 mm)	Short	Medium

All Pads: 13,000 RPM maximum operating speed; 5/16"-24 male thread.

***NOTE:** Our 3" (76 mm) and 3-1/2" (89 mm) pads, without holes, can also be used for vacuum sanding. Vacuum pick-up is around periphery of pad.

Channel Vacuum Pads

Pad Diameter	Part Number	Holes	Thickness	Nap	Density
5" (127 mm)	56250	5	3/8" (10 mm)	Short	Medium
	56253	5	3/8" (10 mm)	Short	Soft
	56255	5	5/8" (16 mm)	Short	Medium
	56257	5	5/8" (16 mm)	Short	Soft
6" (152 mm)	56260	6	3/8" (10 mm)	Short	Medium
	56263	6	3/8" (10 mm)	Short	Soft
	56265	6	5/8" (16 mm)	Short	Medium
	56267	6	5/8" (16 mm)	Short	Soft

Random Orbital Sander Abrasive Discs

DynaCut Aluminum Oxide Paper-Backed Coated Abrasive Discs

The most common mineral for general purpose applications. Ideal for sanding on bare wood, metal, plastic and fiberglass. Also used to prepare primed and painted surfaces for finishing.



ALUMINUM OXIDE COATED ABRASIVES												
Diameter (Inches)	Attachment Type	Vacuum Type (No. of Holes)	36 Grit	40 Grit	60 Grit	80 Grit	120 Grit	150 Grit	180 Grit	220 Grit	320 Grit	Package Quantity
3	PSA	Vacuum (6)	•	•	•	93682	93683	93684	93685	93633	93634	50
3	Hook	Vacuum (6)	•	•	•	93665	93666	93667	93668	93636	93637	50
3	Hook	Non-Vacuum	•	•	92074	92075	92076	92077	92078	92079	92080	50
3	Hook	Vacuum (3)	•	•	92081	92056	92057	92082	92058	92059	92060	50
3-1/2	PSA	Non-Vacuum	•	•	•	79900	79901	79905	79902	79903	79904	Box/100 Pcs.
3-1/2	PSA	Non-Vacuum	•	•	•	79230	79231	79235	79232	79233	79234	Roll/100 Pcs.
3-1/2	Hook	Non-Vacuum	•	•	•	79935	79936	79906	79937	79938	79939	Box/100 Pcs.
5	PSA	Non-Vacuum	•	•	79967	79910	79911	79914	79912	79913	79907	Box/100 Pcs.
5	PSA	Non-Vacuum	•	•	•	79240	79241	79246	79242	79243	79981	Roll/100 Pcs.
5	PSA	Vacuum (5)	•	•	79968	79915	79916	79919	79917	79918	79908	Box/100 Pcs.
5	PSA	Vacuum (5)	•	•	•	79245	79247	79248	79249	79250	79982	Roll/100 Pcs.
5	Hook	Non-Vacuum	•	•	79969	79941	79942	79945	79943	79944	79909	Box/100 Pcs.
5	Hook	Vacuum (5)	•	•	79976	79946	79947	79950	79948	79949	79930	Box/100 Pcs.
5	Hook	Multi-Hole Vac	•	•	•	79961	79962	79963	79964	79965	79966	Box/100 Pcs.
6	PSA	Non-Vacuum	•	•	79977	79920	79921	79924	79922	79923	79931	Box/100 Pcs.
6	PSA	Non-Vacuum	•	•	•	79252	79254	79255	79256	79257	79983	Roll/100 Pcs.
6	PSA	Vacuum (6)	•	•	79978	79925	79926	79929	79927	79928	79932	Box/100 Pcs.
6	PSA	Vacuum (6)	•	•	•	79259	79261	79262	79263	79264	79984	Roll/100 Pcs.
6	Hook	Non-Vacuum	•	•	79979	79951	79952	79955	79953	79954	79933	Box/100 Pcs.
6	Hook	Vacuum (6)	•	•	79980	79956	79957	79960	79958	79959	79934	Box/100 Pcs.
6	Hook	Multi-Hole Vac	•	•	•	79970	79971	79972	79973	79974	79975	Box/100 Pcs.
8	PSA	Non-Vacuum	•	91235	91236	91237	91239	91240	91241	91242	91243	25
8	PSA	Vacuum (8)	•	91247	91248	91249	91251	91244	91245	91246	91248	25
8	Hook	Non-Vacuum	•	91444	91445	91446	91448	91250	91252	91253	91254	25
8	Hook	Vacuum (8)	•	91456	91457	91458	91460	91255	91256	91257	91258	25
11-1/4	Hook	Non-Vacuum	91315	•	91316	91300	91301	•	91302	•	•	10
11-1/4	Hook	Vacuum (0-Style)	91317	•	91318	91303	91304	•	91305	91306	•	10
11-1/4	Hook	Vacuum (5)	•	•	•	•	91309	•	•	•	•	10

DynaCut Aluminum Oxide Film-Backed Abrasive Discs

			ALUMINUM OXIDE COATED ABRASIVES												
Diameter (Inches)	Attachment Type	Vacuum Type	36 Grit	40 Grit	60 Grit	80 Grit	100 Grit	120 Grit	150 Grit	180 Grit	240 Grit	320 Grit	400 Grit	Package Quantity	
5	PSA	Non-Vacuum	•	•	82454	82455	82456	82457	82458	82459	82460	82461	82462	Box/100 Pcs.	
5	PSA	Vacuum (5)	•	•	82465	82466	82467	82468	82469	82470	82471	82472	82473	Box/100 Pcs.	
5	Hook	Non-Vacuum	•	•	82427	82428	82429	82430	82431	82432	82434	82435	82436	Box/100 Pcs.	
5	Hook	Vacuum (Multi-Hole)	•	•	79359	79360	79361	79362	79363	79364	79366	79367	79368	Box/100 Pcs.	
6	PSA	Non-Vacuum	•	•	82476	82477	82478	82479	82480	82481	82482	82483	82484	Box/100 Pcs.	
6	PSA	Vacuum (6)	•	•	82487	82488	82489	82490	82491	82492	82493	82494	82495	Box/100 Pcs.	
6	Hook	Non-Vacuum	•	•	82442	82443	82444	82445	82446	82447	82449	82450	82451	Box/100 Pcs.	
6	Hook	Vacuum (Multi-Hole)	•	•	79374	79375	79376	79377	79378	79379	79381	79382	79383	Box/100 Pcs.	

• Call for availability and pricing.

Random Orbital Sander Abrasive Discs (Cont'd.)

Dynabrade Aluminum Oxide Microfinishing Discs

Diameter (Inches)	Attachment Type	Vacuum Type (No. of Holes)	100 Micron	80 Micron	60 Micron	30 Micron	15 Micron	Package Quantity
11-1/4	Hook	Non-Vacuum	91320	91321	91322	91323	91324	10
11-1/4	Hook	Vacuum (O-Style)	91325	91326	91327	91328	91329	10

Dynabrade Aluminum Oxide Clear Coat Repair Discs

Aluminum Oxide paper-backed discs ideal for spot repair and dust nib repair.

Diameter (Inches)	Attachment Type	Vacuum Type	5 Micron Grade	Package Quantity
1-1/4	PSA	Non-Vacuum	93193	500/Roll

DynaCut Silicon Carbide Coated Abrasive Discs

Silicon Carbide creates a thinner scratch pattern than Aluminum Oxide, due to its sharper grain.

Silicon Carbide cuts faster, but does not last as long as Aluminum Oxide.

SILICON CARBIDE COATED ABRASIVES												Package Quantity
Diameter (Inches)	Attachment Type	Vacuum Type	36 Grit	40 Grit	60 Grit	80 Grit	120 Grit	150 Grit	180 Grit	220 Grit	320 Grit	
3/4	PSA	Non-Vacuum	•	•	•	78160	78161	•	78162	78163	•	Sheet/75 Pcs
1-1/4	PSA	Non-Vacuum	•	•	•	78165	78166	•	78167	78168	•	Sheet/25 Pcs

DynaCut Scalloped-Edge Aluminum Oxide Coated Abrasive Discs

Scalloped-Edge Discs (when paired with Dynabrade Radius Edge Pads) conform to the shape of coves and corners.

Ideal for use on backsplash corners, countertop coves, bowls, sinks, and rounded fiberglass corners.

ALUMINUM OXIDE COATED ABRASIVES												Package Quantity
Diameter (Inches)	Attachment Type	Vacuum Type (No. of Holes)	80 Grit	100 Grit	120 Grit	100 Micron	80 Micron	60 Micron	30 Micron	15 Micron	9 Micron	
3-1/2	Hook	Non-Vacuum	92580	•	92581	92582	•	92583	92584	•	•	50
5	Hook	Non-Vacuum	92590	92597	92591	92592	92587	92593	92594	92588	92589	50
5	Hook	Vacuum (5)	92600	•	92601	92602	•	92603	92604	•	•	50

DynaBrite® Scalloped-Edge Non-Woven Nylon Surface Conditioning Discs

						SURFACE CONDITIONING (NWN)		Package Quantity
Diameter (Inches)	Attachment Type	Vacuum Type (No. of Holes)	Medium Maroon	Fine Gray				
3-1/2	Hook	Non-Vacuum	92585	92586				10
5	Hook	Non-Vacuum	92595	92596				10
5	Hook	Vacuum (5)	92605	92606				10

DynaBrite® Non-Woven Nylon Surface Conditioning Discs

Ideal for surface conditioning, decorative finishing, light/heavy cleaning, blending and polishing.

						SURFACE CONDITIONING (NWN)		Package Quantity
Diameter (Inches)	Attachment Type	Vacuum Type	Coarse (Brown)	Medium (Maroon)	Very Fine (Blue)			
5	Hook	Non-Vacuum	78414	78415	78416			10
6	Hook	Non-Vacuum	78417	78418	78419			10
7	Hook	Non-Vacuum	78420	78421	78422			10

• Call for availability and pricing.

Random Orbital Sander Accessories

"Stays-Tight" Muffler Parts

- Replaceable parts that make up new "Stays-Tight" muffler system.
- Threaded cap keeps muffler firmly attached during use.



57065 Cone Muffler
(Dynorbital® Supreme Only)

56027 Muffler Insert

69359 Threaded Cap

Portable Self-Contained Dust Collection Systems

- For use with Dynabrade Self-Generated Vacuum tools.
- Systems include 1" (25 mm) dia. x 6' (1.8 m) long 50682 Flex-Hose.

Part No. 50617

- Includes 50683 Bag with hook-face closure.

Part No. 56303

- Includes 56304 Bag with zipper-lock closure.



50617

Ball-Swivel Plug

Plug "swivels" for great tool maneuverability!

Part No. 97016

- 97016 Ball-Swivel Plug offers 53° conical range of motion, for added tool maneuverability and operator comfort.
- A natural fit with Dynabrade palm-style Random Orbital Sanders!
- Ported plug design allows air flow of up to 74 SCFM (2,095 LPM).
- Maximum air pressure of 90 PSIG (6.2 Bar).



97016

53° Conical Range of Motion

Electric Portable Vacuum System

- Heavy duty stainless steel drum; variable vacuum control.
- HEPA filtration (0.3 micron) with felt insert and paper bag.
- Electronic thermal protection device prevents heat overload of motor.
- Heavy duty four-wheel trolley with easy "tilt 'n clean" drum.

Model 61300

9.9 Gallon Capacity

- 120V (AC)

Model 61301

17 Gallon Capacity

- 120V (AC)

Portable Vacuums available in many other voltage formats.



61300



Visit our Website for more Tools and Related Accessories
www.dynabrade.com

DYNABRADE, INC. • DYNABRADE INTERNATIONAL

8989 Sheridan Drive • Clarence, New York 14031-1419
Phone: (716) 631-0100 • US Fax: 716-631-2073 • Int'l Fax: 716-631-2524
US Consumers Call Toll-Free: 1-800-828-7333
Canadian Consumers Call Toll-Free: 1-800-344-1488

DYNABRADE EUROPE S.à r.l.

Zone Artisanale Op Tomm 6 • L-5485 Wormeldange—Haut, Luxembourg
Telephone: +352 768 494 1 • Fax: +352 768 495

DYNABRADE DO BRASIL

Rua Oneda, 632 • Sao Bernardo do Campo • SP - CEP 09895-280
Telephone 55-11-4390-0133 • Fax 55-11-4399-1067

DYNABRADE INDIA ABRASIVE POWER TOOLS Pvt Ltd.

EL-54, TTC Industrial Area, M.I.D.C. Mahape, Electronic Zone, Navi Mumbai - 400705
Maharashtra, India • Telephone: +91 22 2763 2226 • Fax: +91 22 2763 2228

Try Our U.S. Consumer Toll-Free Number
1-888 DYNABRADE (or 1-800-828-7333)

DISTRIBUTED BY:

